

Specifications

- Input voltage: 12VDC or 24VDC or 36VDC or 48VDC
- Max thrust: 2000N
- Standard stroke: 50~1000mm
- Full load speed: 4mm/s~45mm/s
- No load speed: 5mm/s~55mm/s
- Duty cycle: 25%
- Ambient temp: -40℃~+65℃
- IP rating: IP66
- Built-in limit switch, non-adjustable
- Low noise design, ≤65dB
- CE certification
- Signal feedback: none or hall or potentiometer
- Color is gray
- Applications: Agricultural machinery, lifting platform, machine tool, electric bed, harvester, baler, etc

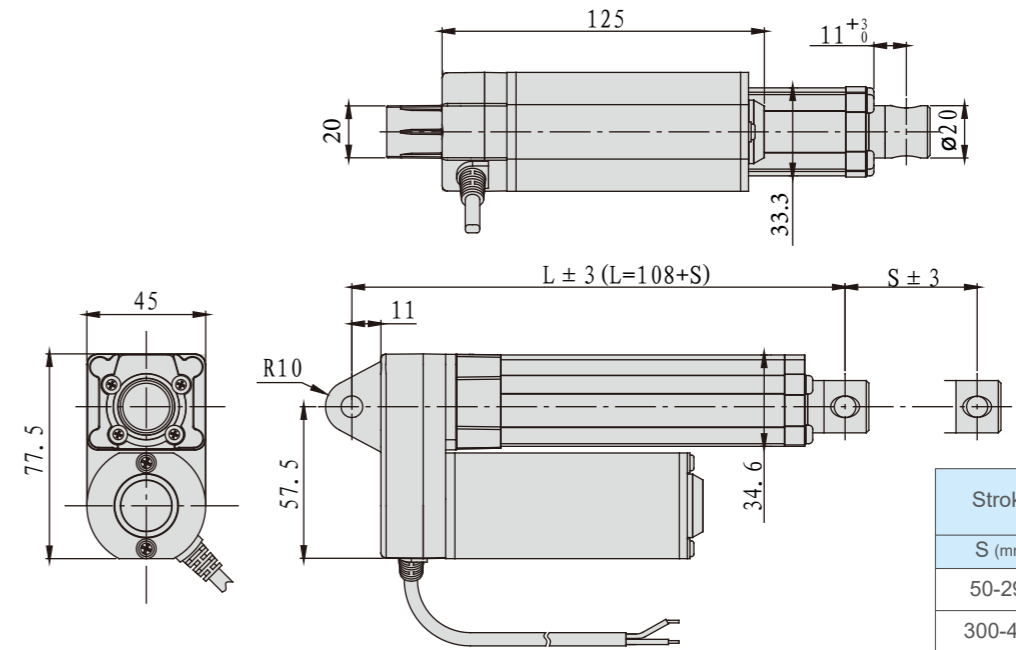

Outline Drawing



Technical Parameters

Transmission Code		A	B	C	D	E	F	G	H	I
Max Dynamic Thrust	N	2000	1600	1200	800	700	600	400	300	200
Self-locking Thrust	N	3000	2200	1600	1100	900	800	600	400	300
No Load Speed	mm/s	5.0	7.0	10.0	10.5	20.0	15.0	30.0	40.0	55.0
Full Load Speed	mm/s	4.0	5.5	8.0	8.0	14.0	11.0	22.0	30.0	45.0
Input Voltage	VDC	12 or 24 or 36 or 48								
Standard stroke	mm	50 to 1000								
Ambient Temperature	℃	-40 to 65								
Cable Length	mm	Customizable								
Color		Gray								
Limit Switch		Build-in								
IP Rating		IP66								
Duty Cycle		25% (2 minutes of continuous work, 6 minutes of rest)								
Signal Feedback		None or hall or potentiometer								

Characteristic Curve

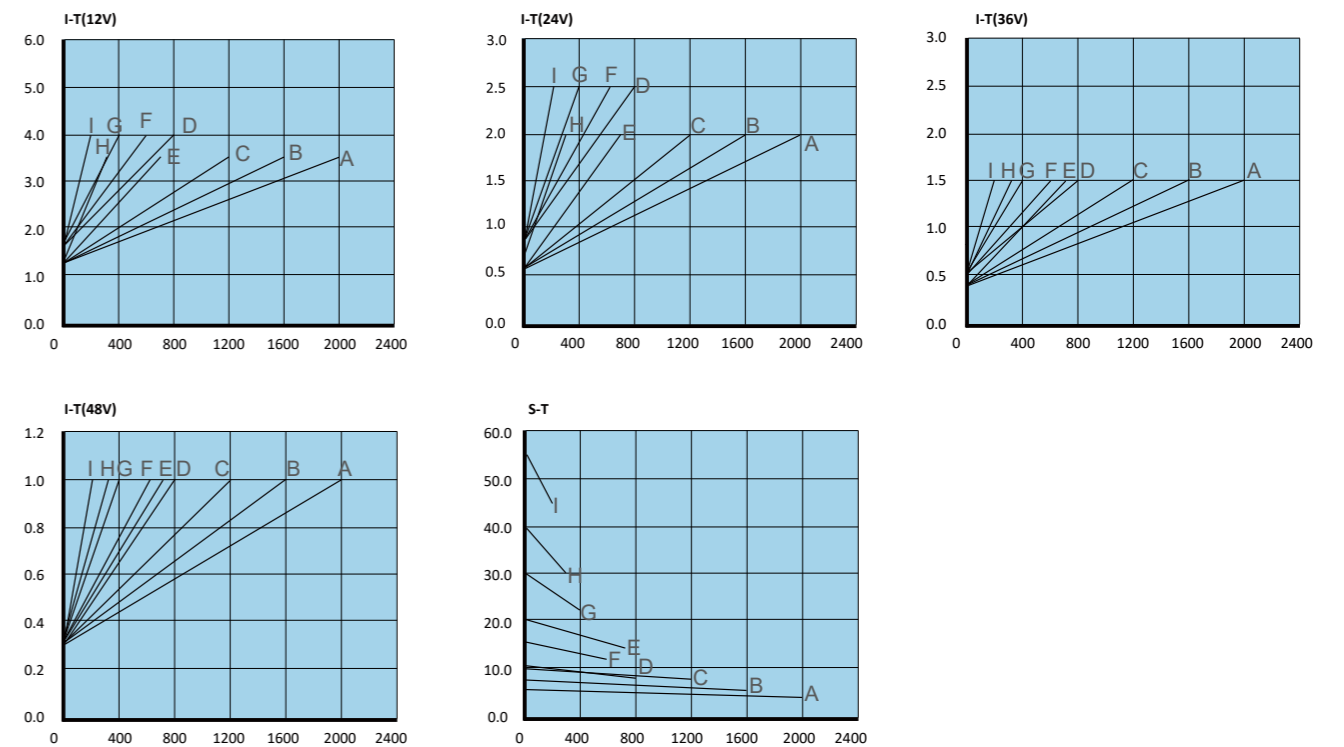

I:Current, T:Thrust, S:Speed