



Motor Characteristics

- ◆ Step Angle: 1.8°
- ◆ Frame Size: 57mm
- ◆ Holding Torque: 1.1-2.5N.m
- ◆ Built-in 1000-line encoder
- ◆ Low heat, High torque
- ◆ High stability, High consistency

Motor Specifications

Model	Phase Current	Phase Resistance	Phase Resistance	Holding Torque	Rotor Inertia	Bi/Unipolar	Weight	Length (L)
	A/Ø	Ω/Ø	mH/Ø	N.cm	g.cm ²	# of Leads	kg	mm
PHSM57S56-430-210EC	3.0	0.8	2.4	1.1	200	Bi(4)	0.8	56
PHSM57S56-440-210EC	4.2	0.4	1.2	1.1	200	Bi(4)	0.8	56
PHSM57S80-430-210EC	3.0	1.2	4.0	2.0	480	Bi(4)	1.15	80
PHSM57S80-440-210EC	4.2	0.7	2.0	2.0	480	Bi(4)	1.15	80
PHSM57S100-430-210EC	3.0	1.4	5.5	2.5	800	Bi(4)	1.55	100
PHSM57S100-440-210EC	4.2	0.7	2.5	2.5	800	Bi(4)	1.55	100

Encoder Specifications

Resolution	1000CPR	
Supply voltage	4.5~5.5V	
Supply current(Max)	100mA	
Signal	A+,A-,B+,B-	
Rise/fall time(Max)	100ns	
Frequency	300kHz	
Output voltage	"H"	2.4V min
	"L"	0.4V Max
Max.output current	20mA	

Encoder Waveform

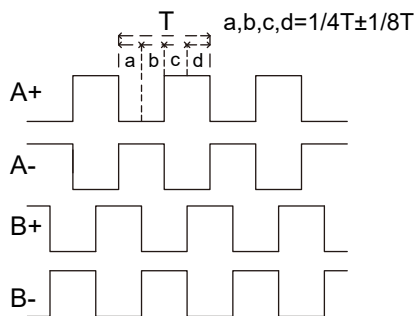

Outline Drawing

- Motor Without Brake

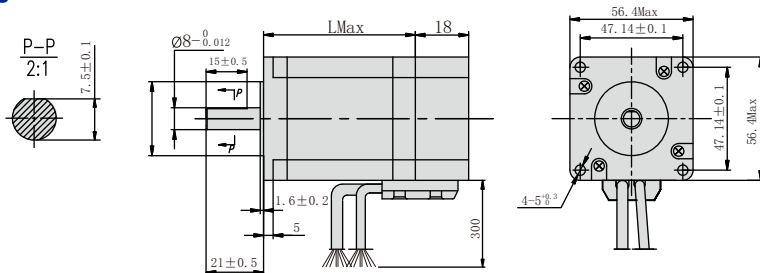

- Motor With Brake

