

42mm series



Motor characteristics

- ◆ Step Angle: 1.8°
- ◆ Frame Size: 42mm
- ◆ Holding Torque: 0.3-0.8N.m
- ◆ Built-in 1000-line encoder
- ◆ Low heat, High torque
- ◆ High stability, High consistency

Motor Specifications

Model	Phase Current	Phase Resistance	Phase Resistance	Holding Torque	Rotor Inertia	Bi/Unipolar	Weight	Length (L)
	A/Ø	Ω/Ø	mH/Ø	N.m	g.cm ²	# of Leads	kg	mm
PHSM42S37-410-210EC	1.3	2.5	5.0	0.3	35	Bi(4)	0.27	37
PHSM42S37-420-210EC	2.3	0.7	2.3	0.3	25	Bi(4)	0.27	37
PHSM42S51-410-210EC	1.3	3.2	5.5	0.5	77	Bi(4)	0.4	51
PHSM42S51-420-210EC	2.3	1.0	1.9	0.5	77	Bi(4)	0.4	51
PHSM42S67-410-210EC	1.3	3.8	8.5	0.8	115	Bi(4)	0.55	67
PHSM42S67-420-210EC	2.3	1.4	3.1	0.8	115	Bi(4)	0.55	67

Encoder Specifications

Resolution	1000CPR	
Supply voltage	4.5~5.5V	
Supply current(Max)	100mA	
Signal	A+,A-,B+,B-	
Rise/fall time(Max)	100ns	
Frequency	300kHz	
Output voltage	"H"	2.4V min
	"L"	0.4V Max
Max.output current	20mA	

Encoder Waveform

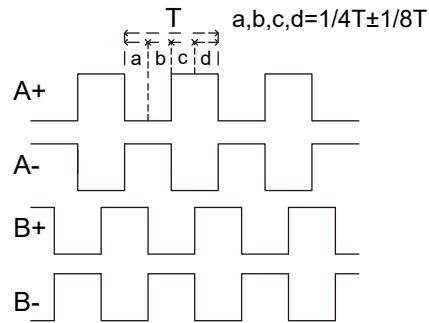

Outline Drawing

Motor Without Brake

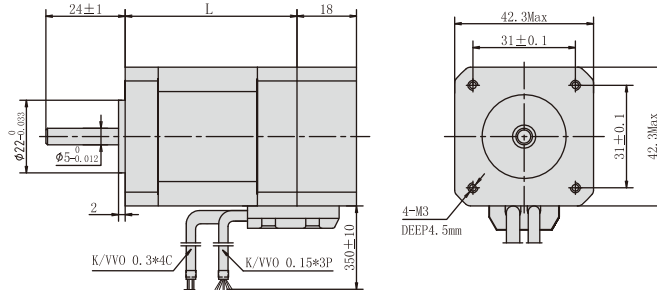

Motor With Brake

