

PBLS70HES Series

Inner Rotor BLDC Motor

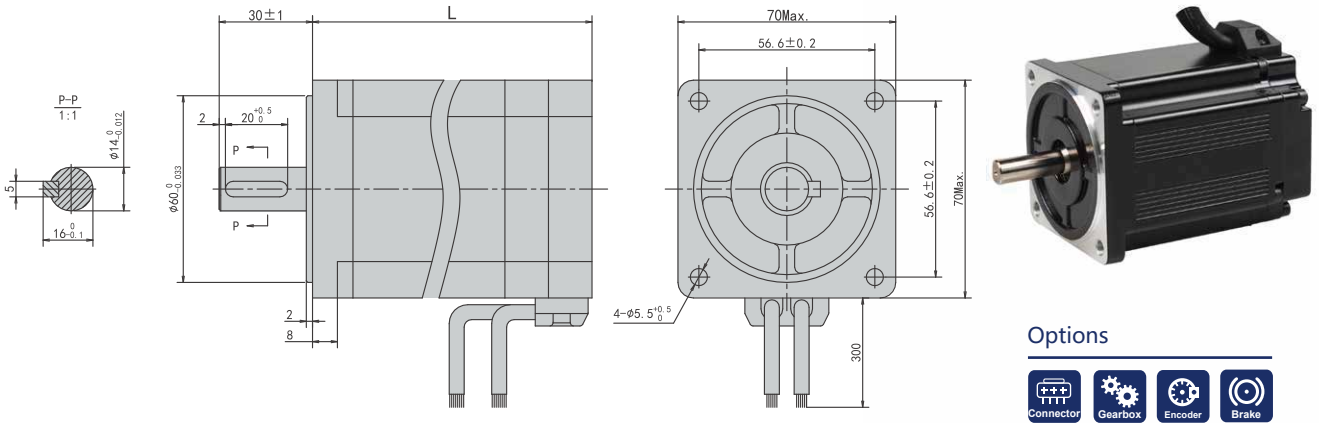

Options



General Specifications

Winding Type	Star/Delta
Hall Effect Angle	Electrical Angle of 120 degree
Radial Play	0.02mm@450g
Axial Play	0.08mm@450g
Max radial force	115N,10mm From the flange
Max axial force	45N
Dielectric Strength	600VAC/1S
Insulation Resistance	100MΩ,500VDC
Ambient Temperature	-20°C~+50°C
Insulation Class	Class B

Wiring Connection

Type	Color	Function
UL1007 AWG26	Red	Vcc
	Yellow	Hu
	Green	Hv
	Blue	Hw
	Black	GND
UL1007 AWG26	Yellow	Phase U
	Green	Phase V
	Blue	Phase W

Motor Specifications

Motor Model	Unit	PBLS70HES481530	PBLS70HES482130
Number of Phase		3	
Number of Poles		8	
Rated Voltage	VDC	48	
Rated Speed	Rpm	3000	
Rated Torque	N.m	0.5	0.67
Rated Power	W	157	210
Rated Current	A	4.1	5.8
Peak Current	A	12.3	17.4
Peak Torque	N.m	1.5	2.01
Rotor Inertia	kg.cm ²	0.86	0.92
Torque Constant	N.m/A	0.122	0.115
Torque Constant	V/krpm	12.76	11.2
Line-Line Resistance	Ω	0.93	0.8
Line-Line Inductance	mH	0.85	0.7
Length	mm	88	98
Weight	kg	1.34	1.5