

PPMG35P Series

● Key Features

- Small Size
- Smooth Movement
- Low Inertia



Step Angle Accuracy	±8%
Resistance Accuracy	±10%
Inductance Accuracy	±20%
Ambient Temperature	-10°C ~ 50°C
Insulation Resistance	100 MΩ Min.(At 500VDC)
Dielectric Strength	RMS for 2 Sec(At 650±50VAC)
Insulation Class	Class E

● Specifications

Series	Model Number	Voltage	Rated Current	Resistance per phase	No-load Starting Freq	Detent Torque	Rotor Inertia	Wiring Diagram	Gear Ratio	No. of Phase	Step Angle
		V/Ø	A	ohm	pps	g.cm/pps	g.cm	Wdg			
PPMG35P19	PPMG35P19-04	12	0.4	30	360	2500/200	10000	a	1:19	4	7.5/19
	PPMG35P19-13	24	0.13	185	430	1300/200	4000	a	1:19	4	7.5/19
PPMG35P08	PPMG35P08-04	12	0.4	30	360	800/300	2000	a	1:8.4	4	7.5/8.4
PPMG35P30	PPMG35P30-04	12	0.4	30	360	2500/300	12000	a	1:30	4	7.5/30
PPMG35P60	PPMG35P60-04	12	0.4	30	360	3000/300	10000	a	1:60	4	7.5/60
PPMG35P120	PPMG35P120-04	12	0.4	30	360	8000/300	10000	a	1:120	4	7.5/120
PPMG35P16	PPMG35P16-23	12	0.23	52.5	470	1300/200	5000	a	1:16	4	7.5/16

● Typical Outline

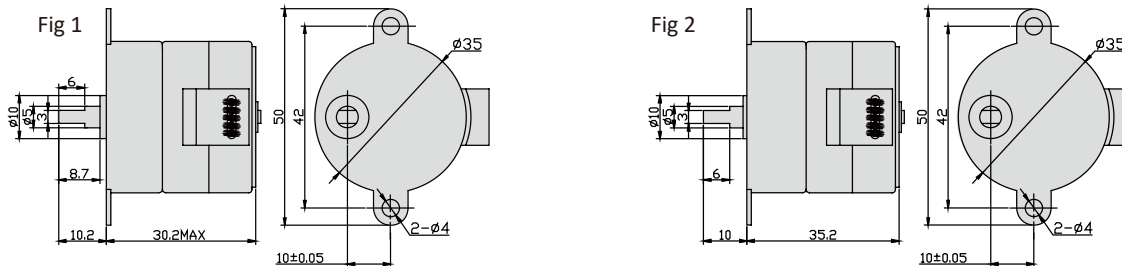

2Phase Hybrid Stepper Motor

3Phase Hybrid Stepper Motor

5Phase Hybrid Stepper Motor

Hybrid Stepper Gear Motor

Lead Screw Linear Actuator

Ball Screw Linear Actuator

IP65 Stepper Motor

Hollow Shaft Stepper Motor

Stepper Motor With Brake

Pancake Stepper Motor

PM Stepper Motor

Can-Stack Stepper Linear Actuator

PM Stepper Gear Motor

Stepper Motor Drive

PPMG35P Series

● **Typical Outline**

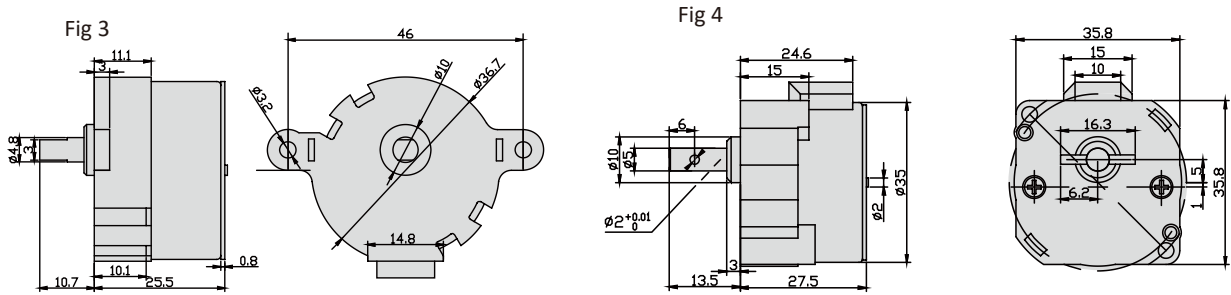

● **Wiring Diagram**

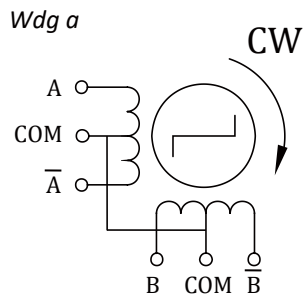

2Phase Hybrid Stepper Motor

3Phase Hybrid Stepper Motor

5Phase Hybrid Stepper Motor

Hybrid Stepper Gear Motor

Lead Screw Linear Actuator

Ball Screw Linear Actuator

IP65 Stepper Motor

Hollow Shaft Stepper Motor

Stepper Motor With Brake

Pancake Stepper Motor

PM Stepper Motor

Can-Stack Stepper Linear Actuator

PM Stepper Gear Motor

Stepper Motor Drive