

PPMS57 Series

● Key Features

- Small Size
- Smooth Movement
- Low Inertia



Step Angle Accuracy	±8%
Resistance Accuracy	±10%
Inductance Accuracy	±20%
Ambient Temperature	-10°C ~ 50°C
Insulation Resistance	100 MΩ Min.(At 500VDC)
Dielectric Strength	RMS for 2 Sec(At 650±50VAC)
Insulation Class	Class E

● Specifications

Series	Model Number	Holding Torque	Rated Current	Resistance per phase	Detent Torque	Rotor Inertia	Wiring Diagram	Drawing	No. of Phase	Step Angle
		g.cm	A	ohm	g.cm	g.cm ²	Wdg	Fig		
PPMS57L48	PPMS57L48-01	1500	0.6	21	425	12.5	b	1	4	7.5
	PPMS57L48-02	1200	0.625	9	425	12.5	a	2	2	7.5

● Typical Outline

Fig 1

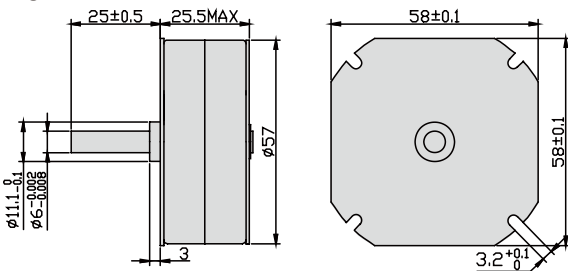
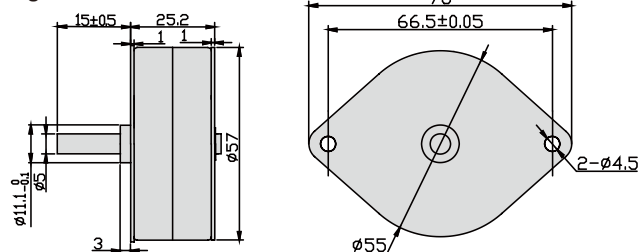
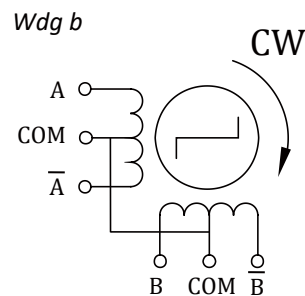
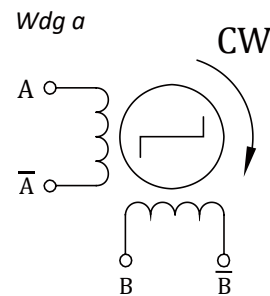

Fig 2



● Wiring Diagram



2Phase Hybrid Stepper Motor

3Phase Hybrid Stepper Motor

5Phase Hybrid Stepper Motor

Hybrid Stepper Gear Motor

Lead Screw Linear Actuator

Ball Screw Linear Actuator

IP65 Stepper Motor

Hollow Shaft Stepper Motor

Stepper Motor With Brake

Pancake Stepper Motor

PM Stepper Motor

Can-Stack Stepper Linear Actuator

PM Stepper Gear Motor

Stepper Motor Drive