

PHB39Y Series

● **Key Features**

- High Speed
- Small Size
- High Acceleration

● **Option**

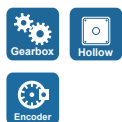

Step Angle	1.8°
Step Angle Accuracy	±5% (full step, no load)
Resistance Accuracy	±10%
Inductance Accuracy	±20%
Temperature Rise	80 °C Max.(rated current, 2 phase on)
Ambient Temperature	-20 °C ~ +50 °C
Insulation Resistance	100 MΩ Min., 500VDC
Dielectric Strength	500 VAC for one minute
Shaft Radial Play	0.02 Max. (450 g-load)
Shaft Axial Play	0.08 Max. (450 g-load)

● **Specifications**

- Bi-polar

Series & Length	Model Number	Holding Torque		Rated Current	Resistance per phase	Inductance per phase	Detent Torque		Rotor Inertia	
		N.cm	oz-in				N.cm	oz-in	g.cm ²	oz-in ²
PHB39Y20 20mm	PHB39Y20-401	8	11.2	0.42	18	12	0.5	0.7	12	0.066
PHB39Y26 26mm	PHB39Y26-401	14	19.6	0.6	9	10	0.8	1.12	14	0.077
PHB39Y34 34mm	PHB39Y34-401	18	25.2	0.6	12	13	1.0	1.4	19	0.105
	PHB39Y34-402	18	25.2	1.2	3.2	3.0	1.0	1.4	19	0.105
PHB39Y40 40mm	PHB39Y40-401	24	33.6	0.6	12	20	1.2	1.68	24	0.132
	PHB39Y40-402	24	33.6	1.2	3.8	6.5	1.2	1.68	24	0.132

- Uni-polar

Series & Length	Model Number	Holding Torque		Rated Current	Resistance per phase	Inductance per phase	Detent Torque		Rotor Inertia	
		N.cm	oz-in				N.cm	oz-in	g.cm ²	oz-in ²
PHB39Y34 34mm	PHB39Y34-630	12	16.8	0.4	30	14	1.0	1.4	19	0.105
PHB39Y40 40mm	PHB39Y40-630	18	25.2	0.4	30	22	1.2	1.68	24	0.132

● **Mechanical Dimension**

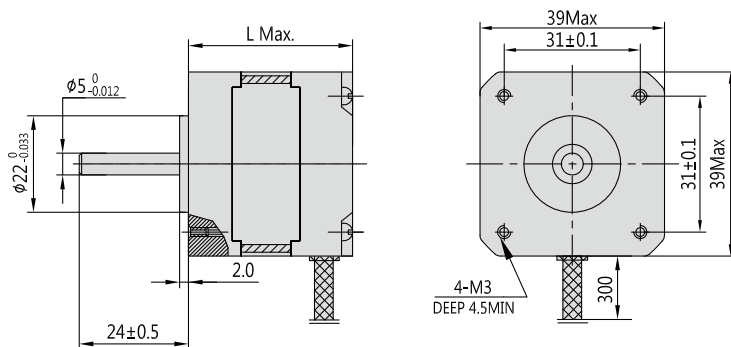

Series	L	Mass
	mm (in.)	g (lb.)
PHB39Y20	20 (1.10)	100 (0.22)
PHB39Y26	26 (1.29)	120 (0.26)
PHB39Y34	34 (1.61)	160 (0.35)
PHB39Y40	40 (1.96)	210 (0.46)