

PHB39M Series

Key Features

- Low Noise
- Small Size
- Smooth Movement

Option



Step Angle	0.9°
Step Angle Accuracy	±5% (full step, no load)
Resistance Accuracy	±10%
Inductance Accuracy	±20%
Temperature Rise	80 °C Max.(rated current, 2 phase on)
Ambient Temperature	-20 °C ~ +50 °C
Insulation Resistance	100 MΩ Min., 500VDC
Dielectric Strength	500 VAC for one minute
Shaft Radial Play	0.02 Max. (450 g-load)
Shaft Axial Play	0.08 Max. (450 g-load)

Specifications

- Bi-polar

Series & Length	Model Number	Holding Torque		Rated Current	Resistance per phase	Inductance per phase	Detent Torque		Rotor Inertia	
		N.cm	oz-in				N.cm	oz-in	g.cm ²	oz-in ²
PHB39M20 20mm	PHB39M20-401	8	11.2	0.42	20	16	0.5	0.7	15	0.083
PHB39M26 26mm	PHB39M26-401	14	19.6	0.6	9	16	0.8	1.12	18	0.099
PHB39M34 34mm	PHB39M34-401	16	22.4	0.6	9	15	1.1	1.54	23	0.127
	PHB39M34-402	16	22.4	1.2	2.5	3.6	1.1	1.54	23	0.127
PHB39M40 40mm	PHB39M40-401	22	30.8	0.6	12	20	1.4	1.96	30	0.165
	PHB39M40-402	22	30.8	1.2	3.2	5.5	1.4	1.96	30	0.165

- Uni-polar

Series & Length	Model Number	Holding Torque		Rated Current	Resistance per phase	Inductance per phase	Detent Torque		Rotor Inertia	
		N.cm	oz-in				N.cm	oz-in	g.cm ²	oz-in ²
PHB39M34 34mm	PHB39M34-630	12	16.8	0.4	30	16	1.1	1.54	23	0.127
PHB39M40 40mm	PHB39M40-630	18	25.2	0.4	30	26	1.4	1.96	30	0.165

Mechanical Dimension

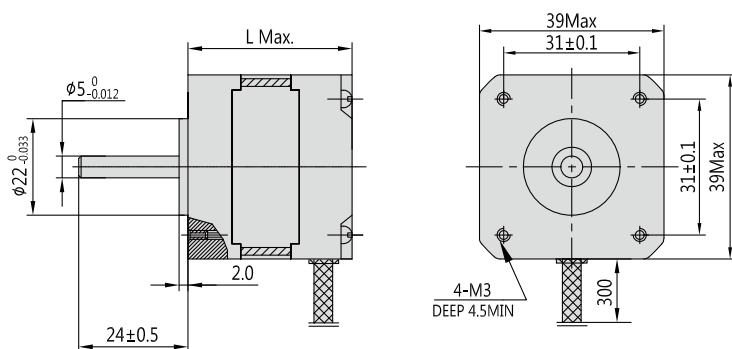

Series	L	Mass
	mm (in.)	g (lb.)
PHB39M20	20 (1.10)	100 (0.22)
PHB39M26	26 (1.29)	120 (0.26)
PHB39M34	34 (1.61)	160 (0.35)
PHB39M40	40 (1.96)	210 (0.46)

2Phase Hybrid Stepper Motor

3Phase Hybrid Stepper Motor

5Phase Hybrid Stepper Motor

Hybrid Stepper Gear Motor

Lead Screw Linear Actuator

Ball Screw Linear Actuator

IP65 Stepper Motor

Hollow Shaft Stepper Motor

Stepper Motor With Brake

Pancake Stepper Motor

PM Stepper Motor

Can-Stack Stepper Linear Actuator

PM Stepper Gear Motor

Stepper Motor Drive