

PHB25Y Series

● Key Features ● Option

- Small Size
- Smooth Movement
- Low Inertia

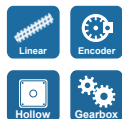

Step Angle	1.8°
Step Angle Accuracy	±5% (full step, no load)
Resistance Accuracy	±10%
Inductance Accuracy	±20%
Temperature Rise	80 °C Max.(rated current, 2 phase on)
Ambient Temperature	-20 °C ~ +50 °C
Insulation Resistance	100 MΩ Min., 500VDC
Dielectric Strength	500 VAC for one minute
Shaft Radial Play	0.02 Max. (450 g-load)
Shaft Axial Play	0.08 Max. (450 g-load)

● Specifications

- Bi-polar

Series & Length	Model Number	Holding Torque		Rated Current	Resistance per phase	Inductance per phase	Lead Wire	Rotor Inertia	
		N.cm	oz-in	A	ohm	mH	(No.)	g.cm ²	oz-in ²
PHB25Y33 33mm	PHB25Y33-401	5.0	7.0	0.67	5.5	3.2	4	8	0.044
	PHB25Y33-402	5.0	7.0	0.35	15	9.2	4	8	0.044
PHB25Y41 41mm	PHB25Y41-401	6.0	8.4	0.67	7.0	6.0	4	11	0.061
	PHB25Y41-402	6.0	8.4	0.35	20	15	4	11	0.061
PHB25Y50 50mm	PHB25Y50-401	8.0	11.2	0.67	9.0	7.2	4	13	0.072
	PHB25Y50-402	8.0	11.2	0.35	24	18.5	4	13	0.072

● Mechanical Dimension

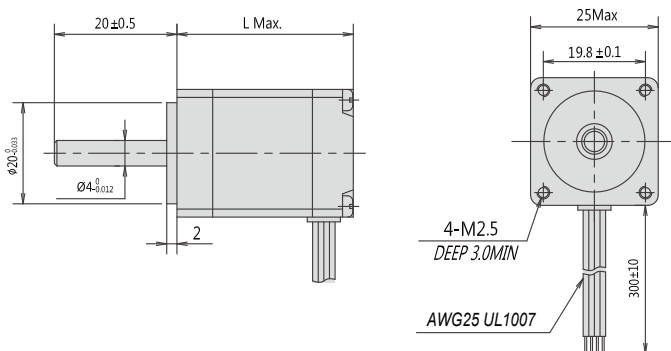

Series	L	Mass
	mm (in.)	g (lb.)
PHB25Y33	33 (1.30)	110 (0.24)
PHB25Y41	41 (1.61)	140 (0.31)
PHB25Y50	50 (1.97)	180 (0.40)