

我们公司的承诺：可靠的质量/及时的供货/最佳的服务



盐城市锦东液压机械有限公司
YANCHENG JINDONG HYDRAULIC MACHINE CO.,LTD.

地址：江苏省建湖县建高路西葛
联系人：陈经理 手机：13705116112
电话：400-6606-508
传真：400-6981-163 分机号：228501
邮箱：cjd@vip.163.com
网址：<http://www.jsjdy.com>
<http://jsjdy.en.alibaba.com>



客户的满意，我的**追求**
Customer satisfaction, our pursuit

液压快速接头
Hydraulic Quick Coupling

JinDong HYDRAULIC



中国·江苏

盐城市锦东液压机械有限公司
YANCHENG JINDONG HYDRAULIC MACHINE CO.,LTD.



客户的满意，我们的

追求



质量第一，信誉第一
客户第一，服务第一

城市锦东液压机械有限公司
ANCHENG CITY HINDONG HYDRAULIC MACHINERY CO., LTD

地址：江苏省建湖县建高路西葛 联系人：陈经理 手机：13705116112
电话：400-6606-508 传真：400-6981-163 分机号：228501
邮箱：cjd@vip.163.com 网址：http://www.jsjddy.com http://jsjddy.en.alibaba.com

全国免费热线：400-6606-508

公司简介

盐城市锦东液压机械有限公司始建于2001年，是一家专业从事液压快速接头、气动快速接头、旋转接头、单向阀、管接头研发、设计、制造和销售为一体的高新技术企业。以自主研发为主导，以转化国外著名品牌为特色，以生产超高压快速接头为专长，在消化吸收的同时致力于创新。集十余年之经验，产品的质量稳定，性能可靠。公司占地面积10000平方米，建筑面积7000平方米。2012年年产液压快速接头20万PCS、气动快速接头20万PCS、管接头10万PCS。



“FREE FIT”牌ISO、GB、Q/ZB275标准系列的各种液压、气动快速接头及管接头产品指标均符合或超过GB、ISO标准，产品广泛用于机械、消防、船舶、高铁、军事、医疗、航空、钢铁、化工、电力、石油、机械工程等设施设备的连接及终端，远销北美、欧洲、中东、亚洲等30多个国家和地区。公司正在申请国家级高新技术企业、江苏省富士康合同重信用企业，盐城市诚信企业、盐城市名牌产品等多项荣誉。公司经营理念：永远以“诚信和品质”求发展，绝不会用短期的利益出卖未来！

引领科技 追求卓越

我公司本着“质量第一、信誉第一、客户第一、服务第一”的企业宗旨，“客户的满意、我们的追求”的企业目标，竭诚欢迎各位新老客户光临指导，合作创业、我们相信在大家的共同努力下，一定能与方大客户一起携手并进，共创美好未来！



目录 CONTENTS



液压快速接头 HYDRAULIC QUICK COUPLING

| | |
|---|-----|
| FF 平面式液压快速接头 | P02 |
| Flat Face Type Hydraulic Quick Coupling ISO16028 | |
| 3FFH 平面式液压快速接头 | P03 |
| Flat Face Type Hydraulic Quick Coupling ISO16028 | |
| ANV 开闭式液压快速接头 | P04 |
| Close Type Hydraulic Quick Coupling ISO7241A | |
| HNV 开闭式液压快速接头 | P05 |
| Close Type Hydraulic Quick Coupling ISO7241B | |
| IRS 推拉式液压快速接头 | P06 |
| Push And Pull Type Hydraulic Quick Coupling ISO5675 | |
| NS 钢球式液压快速接头 | P07 |
| Ball Valves Type Hydraulic Quick Coupling ISO5675 | |
| 3CFPV 液压快速接头 | P08 |
| Hydraulic Quick Coupling ISO7241A | |
| NV 开闭式液压快速接头 | P09 |
| Close Type Hydraulic Quick Coupling ISO5675 | |
| TFH 开闭式液压快速接头 | P10 |
| Close Type Hydraulic Quick Coupling | |
| VF 开闭式液压快速接头 | P11 |
| Close Type Hydraulic Quick Coupling ISO5676 | |
| ST 开通式液压快速接头 | P12 |
| Straight-Through Type Hydraulic Quick Coupling | |
| DF 测试液压快速接头 | P13 |
| Diagnostic Type Hydraulic Quick Coupling ISO15171-1 | |
| 125 开闭式高压液压快速接头 | P14 |
| Close Type Super High Pressure Hydraulic Quick Coupling | |
| HPA 螺纹锁紧式液压快速接头 | P15 |
| Thread Locked Type Hydraulic Quick Coupling ISO14540 | |
| AVE 螺纹锁紧式液压快速接头 | P16 |
| Thread Locked Type Hydraulic Quick Coupling ISO14541 | |
| TGW 螺纹锁紧式液压快速接头 | P17 |
| Thread Locked Type Hydraulic Quick Coupling | |
| VVS 螺纹锁紧式液压快速接头 | P18 |
| Thread Locked Type Hydraulic Quick Coupling | |
| FB 螺纹锁紧式液压快速接头 | P19 |
| Thread Locked Type Hydraulic Quick Coupling | |
| VCR 螺纹锁紧式液压快速接头 | P20 |
| Thread Locked Type Hydraulic Quick Coupling | |
| SVQ 螺纹锁紧式液压快速接头 | P21 |
| Thread Locked Type Hydraulic Quick Coupling | |
| VEP 平面螺纹锁紧式液压快速接头 | P22 |
| Flat Face Thread Locked Type Hydraulic Quick Coupling | |
| 4BD4FH 模块阀系列 | P23 |
| Modular Valve Series ISO16028 | |
| P5065 多路快速接头组合板系列 | P25 |
| Multi-couplings series | |

FF 系列 FF 平面式液压快速接头 FF Type Hydraulic Quick Couplings

材料 Materials:

母件 Coupling: 碳钢镀锌 Steel (zinc chromate plating)
 插头 Nipple: 高性能碳钢, 局部热处理强化
 High grade carbon steel with heat treated wear parts

技术特征 Features:

符合 ISO 16028 系列标准 Interchangeability according to ISO16028
 无溢流阀设计, 在连接最小的空气混入, 断开时很少的流体泄露及容易清洁。
 Flush-faced poppet for a minimal air inclusion when connecting, minima fluid loss during disconnection and for an easy cleaning
 插头和套圈经过淬火处理, 能经受住冲击而造成的机械损坏。
 Both sleeve and nipple are hardened to make the couplings resistant to damage from brinelling and mechanical shock
 最小的降压。
 minimal pressure drop

安全锁定机构, 防止意外断开, 插入既锁定机构, 连接时, 允许单手操作。
 A safety sleeve lock prevents accidental disconnection Push-to-connect operation allows one hand operation when connecting the coupling
 可选配防尘帽及多种螺纹可供选择。
 Dust caps available, Female pipe and BSPP or NPT tread are available upon request

互换性 Interchange:

派克 Parker FE/FF/FEM Series .Hansen Qa2900
 Foster FF series Faster FF Cejn X62

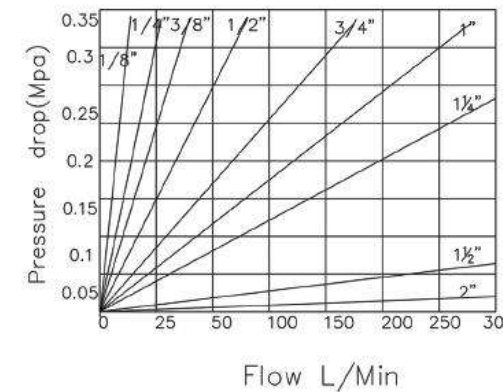

| 技术规范 SPECIFICATIONS | | | | | | | | | |
|--|-----------------|-----|-----|-----|-----|-----|-------|-------|-----|
| 规格(英寸) Body Size(Inch) | 1/8 | 1/4 | 3/8 | 1/2 | 3/4 | 1 | 1 1/4 | 1 1/2 | 2 |
| 额定压力(Mpa) Rate Pressure | 35 | 35 | 35 | 35 | 30 | 25 | 25 | 25 | 20 |
| 额定流量(L/Min) Rated Flow | 12 | 15 | 30 | 50 | 90 | 125 | 185 | 370 | 750 |
| 温度范围(聚氨酯) Temperature Range (polyurethane) | -25°C to +125°C | | | | | | | | |

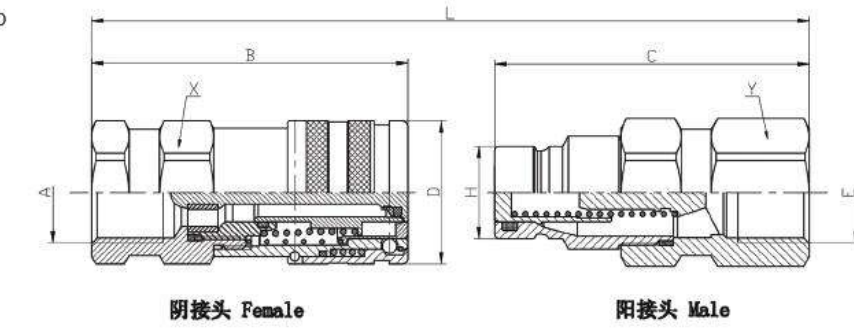

| PART NO | ISO | A | E | L | B | C | H | D | X | Y |
|------------------|------|--------|--------|------|------|-------|-------|-----|----|----|
| FF-01C-18BSP-SP | 3.2 | G1/8 | G1/8 | 68.5 | 40 | 36.5 | 11.6 | 20 | 19 | 17 |
| FF-02C-14BSP-SP | 6.3 | G1/4 | G1/4 | 108 | 58.5 | 60 | 16.1 | 27 | 24 | 24 |
| FF-03C-38BSP-SP | 10 | G3/8 | G3/8 | 134 | 73 | 77 | 19.7 | 30 | 27 | 27 |
| FF-04C-12BSP-SP | 12.5 | G1/2 | G1/2 | 142 | 81 | 75 | 24.5 | 38 | 34 | 34 |
| FF-06C-34BSP-SP | 16 | G3/4 | G3/4 | 169 | 92 | 91 | 27 | 42 | 38 | 38 |
| FF-08C-1BSP-SP | 19 | G1 | G1 | 180 | 100 | 102 | 29.9 | 48 | 41 | 41 |
| FF-10C-114BSP-SP | 25 | G1 1/4 | G1 1/4 | 186 | 100 | 106 | 36 | 55 | 55 | 55 |
| FF-12C-112BSP-SP | 32 | G1 1/2 | G1 1/2 | 213 | 118 | 122.5 | 57.05 | 80 | 70 | 70 |
| FF-16C-2BSP-SP | 48 | G2 | G2 | 251 | 149 | 139.5 | 72.9 | 100 | 80 | 80 |

3FFH系列 3FFH 平面式液压快速接头 3FFH Type Hydraulic Quick Couplings

材料Materials:

插头Nipple:高性能碳钢, 局部热处理 强化
High grade carbon steel with heat treated wear parts

技术特征Features:

符合ISO 16028系列标准 Interchangeability according to ISO16028
无溢流阀设计, 在连接最小的空气混入, 断开时很少的流体泄露及容易清洁。
Flush-faced poppet for a minimal air inclusion when connecting, minima fluid loss during disconnection and for an easycleaning
阳接头带压时可连接。
Connectable with male part under pressure
关键部位经过淬火处理, 持久耐用。
Critical parts are induction hardened for durability
可选配防尘帽。
Dust caps available

互换性Interchange:

Faster 3FFH ,DNP PLK4

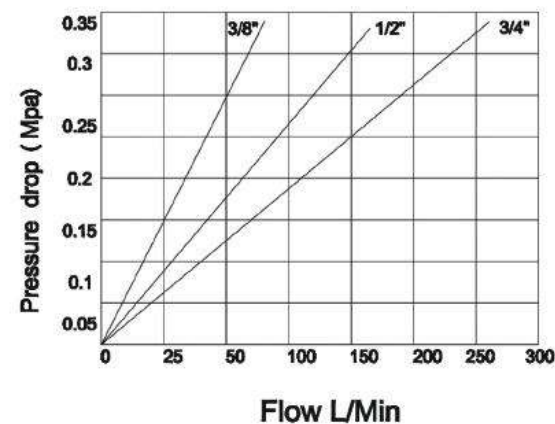

| 技术规范SPECIFICATIONS | | | |
|--------------------------------|---------------|-----|-----|
| 规格(英寸)Body Size(Inch) | 3/8 | 1/2 | 3/4 |
| 额定压力(Mpa)Rate Pressure | 35 | 35 | 35 |
| 额定流量(L/Min)Rated Flow | 35 | 65 | 115 |
| 温度范围(丁晴)Temperture Range (NBR) | -25°Cto+125°C | | |

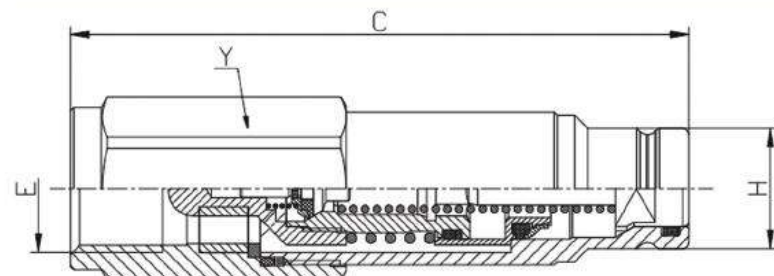

阳接头 Male

| PART NO | ISO | A | H | C | Y |
|-------------------|------|------|------|-----|----|
| 3FFH-03C-38BSP-SP | 10 | G3/8 | 19.7 | 97 | 30 |
| 3FFH-04C-12BSP-SP | 12.5 | G1/2 | 24.5 | 116 | 34 |
| 3FFH-05C-34BSP-SP | 19 | G3/4 | 29.9 | 128 | 42 |

| A | O.D | L | A | O.D | L | A | L |
|---------|-----|----|---------|-----|----|---------|----|
| N16X1.5 | L10 | 11 | N16X1.5 | L10 | 26 | G3/8 | 10 |
| M18X1.5 | S10 | 12 | M18X1.5 | S10 | 27 | M18X1.5 | 10 |
| M20X1.5 | S12 | 12 | M20X1.5 | S12 | 27 | G1/2 | 12 |
| M22X1.5 | S14 | 14 | M22X1.5 | S14 | 27 | M22X1.5 | 12 |
| M24X1.5 | S16 | 14 | M24X1.5 | S16 | 29 | G3/4 | 14 |
| M26X1.5 | L18 | 12 | M26X1.5 | L18 | 34 | M27X1.5 | 14 |

ANV系列 ANV 液压快速接头 ANV Hydraulic Quick Couplings

材料Materials:

母件Coupling:碳钢镀锌Steel (zinc chromate plating)
插头Nipple:高性能碳钢, 局部热处理 强化。
High grade carbon steel with heat treated wear parts

技术特征Features:

符合ISO 7241-1 A系列标准 Interchangeability according to ISO7241-1 part A
O型圈额外提供PTFE支撑环,应用与髙压力环境。
Provide an additional O-ring PTFE support ring,Applies to high pressure environment
插头和套圈经过淬火处理, 能经受住冲击而造成的的机械损坏。
Both sleeve and nipple are hardened to make the couplings resistant to damage frow brinelling and mechanical shock
耐用球锁机制确保每次都可靠连接。
The durable-ball-locking mechanism ensures a reliable connection every time
锥阀组合性密封,更好保证气密性密封, 并将由于髙速流体所造成的密封性剥蚀和损坏程度降至最低。
Captive valve seal assures poppet sealing The valve seal is positively captured by the metal popet to minimize seal washout or damage frow high velocity fluid
可选配防尘帽及多种螺纹可供选择。
Dust caps available, Female pipe and BSPP or NPT tread are available upon request

互换性Interchange:

派克Parker 6600日东 Nitto 280.Hansen Ha15000
Foster A series Faster ANV Cejn X95

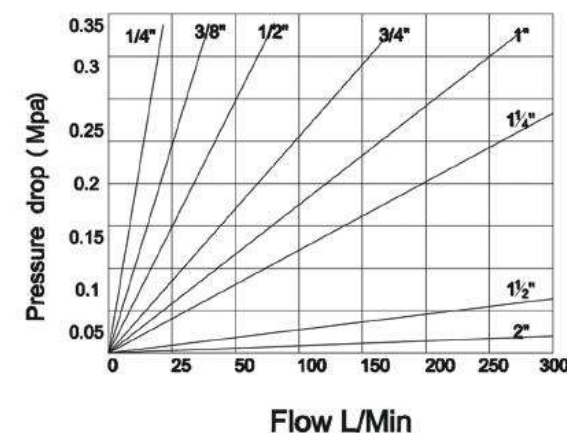

| 技术规范SPECIFICATIONS | | | | | | | | |
|--------------------------------|---------------|-----|-----|-----|-----|-------|-------|-----|
| 规格(英寸)Body Size(Inch) | 1/4 | 3/8 | 1/2 | 3/4 | 1 | 1 1/4 | 1 1/2 | 2 |
| 额定压力(Mpa)Rate Pressure | 50 | 30 | 30 | 30 | 25 | 25 | 20 | 15 |
| 额定流量(L/Min)Rated Flow | 9 | 30 | 75 | 180 | 270 | 330 | 450 | 900 |
| 温度范围(丁晴)Temperture Range (NBR) | -25°Cto+125°C | | | | | | | |

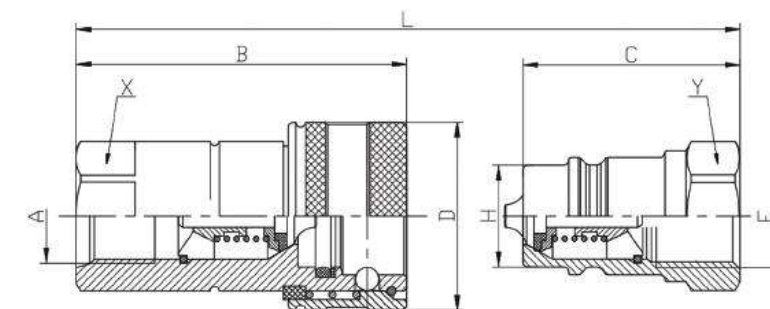

阴接头 Female

阳接头 Male

| PART NO | ISO | A | E | L | B | C | H | D | X | Y |
|-------------------|------|--------|--------|------|-----|------|------|-----|----|----|
| ANV-02C-14BSP-SP | 6.3 | G1/4 | G1/4 | 65.5 | 48 | 32.7 | 11.8 | 25 | 19 | 19 |
| ANV-03C-38BSP-SP | 10 | G3/8 | G3/8 | 81 | 57 | 39 | 17.2 | 32 | 24 | 22 |
| ANV-04C-12BSP-SP | 12.5 | G1/2 | G1/2 | 88 | 66 | 46 | 20.5 | 38 | 27 | 27 |
| ANV-06C-34BSP-SP | 20 | G3/4 | G3/4 | 110 | 83 | 55 | 29 | 48 | 34 | 34 |
| ANV-08C-1BSP-SP | 25 | G1 | G1 | 132 | 100 | 66 | 34.3 | 56 | 41 | 41 |
| ANV-10C-114BSP-SP | 31.5 | G1 1/4 | G1 1/4 | 146 | 115 | 73 | 44.9 | 70 | 50 | 50 |
| ANV-12C-112BSP-SP | 40 | G1 1/2 | G1 1/2 | 166 | 133 | 83 | 55 | 84 | 60 | 60 |
| ANV-16C-2BSP-SP | 50 | G2 | G2 | 200 | 161 | 100 | 65 | 100 | 75 | 75 |

HNV 系列 HNV 液压快速接头 HNV Hydraulic Quick Couplings

材料Materials:

母件Coupling: 碳钢镀锌Steel (zinc chromate plating)
插头Nipple: 高性能碳钢, 局部热处理强化
High grade carbon steel with heat treated wear parts

技术特征Features:

符合ISO 7241-1 B系列标准 Interchangeability according to ISO7241-1 part B
广泛的材料应用, 密封件, 及终端配置, 适合于任何类型的工业应用。
Can be used for any type of industrial applications because of the broad range of materials seals and end configurations
碳钢和不锈钢体密封圈带支撑环, 防止高流速被冲出. 黄铜为双密封圈以备在低压或真空环境下应用。
Body seal Steel and stainless steel versions feature PTFE back-up ring which prevents seal washout at high flow rates Brass couplers have a double essure and vacuum applications
耐用球阀机制确保每次都可靠连接。
The durable-ball-locking mechanism ensures a reliable connection every time
锥阀组合性密封, 更好保证气密性密封, 并将由于高速流体所造成的密封性剥蚀和损坏程度降至最低。
Captive valve seal assures poppet sealing The valve seal is positively captured by the metal popet to minimize seal washout or damage from high velocity fluid
可选配防尘帽及多种螺纹可供选择。
Dust caps available, Female pipe and BSPP or NPT tread are available upon request

互换性Interchange:

派克Parker 60日东 Nitto 250.Hansen Bx-75
Fenster HY-S sariac ,Faster HNV



| 技术规范SPECIFICATIONS | | | | | | | | | |
|--------------------------------|-----------------|-----|-----|-----|-----|-----|-------|------|--|
| 规格(英寸)Body Size(Inch) | 1/8 | 1/4 | 3/8 | 1/2 | 3/4 | 1 | 1 1/2 | 2 | |
| 额定压力(Mpa)Rate Pressure | 50 | 45 | 35 | 35 | 25 | 25 | 14 | 9 | |
| 额定流量(L/Min)Rated Flow | 5 | 17 | 50 | 75 | 190 | 270 | 750 | 1600 | |
| 温度范围(丁晴)Temperture Range (NBR) | -25°C to +125°C | | | | | | | | |

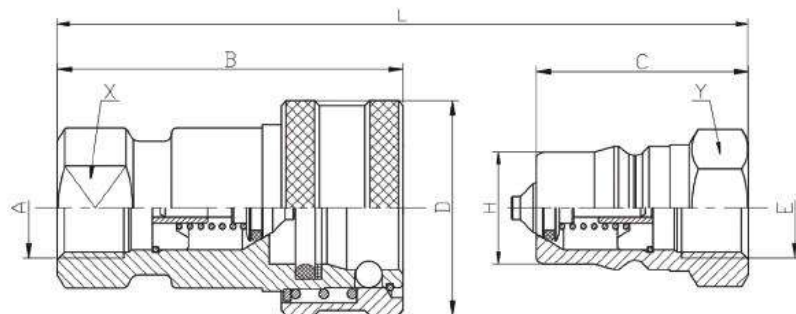
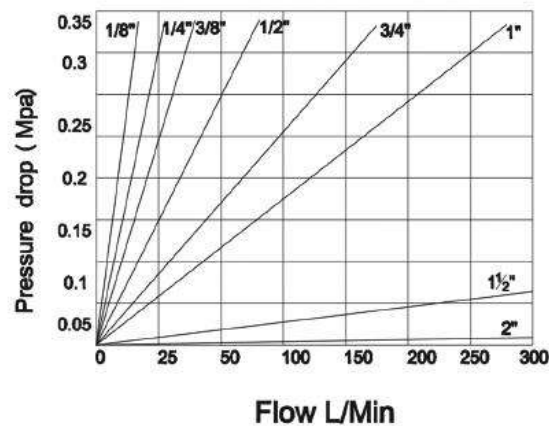

阴接头 Female

阳接头 Male

| PART NO | ISO | A | E | L | B | C | H | D | X | Y |
|-------------------|------|--------|--------|-----|-----|-----|------|-----|----|----|
| HNV-01C-18BSP-SP | 5 | G1/8 | G1/4 | 63 | 50 | 32 | 10.8 | 23 | 17 | 17 |
| HNV-02C-14BSP-SP | 6.3 | G1/4 | G1/4 | 70 | 56 | 35 | 14.1 | 28 | 19 | 19 |
| HNV-03C-38BSP-SP | 10 | G3/8 | G3/8 | 78 | 64 | 39 | 19 | 35 | 24 | 22 |
| HNV-04C-12BSP-SP | 12.5 | G1/2 | G1/2 | 88 | 72 | 44 | 23.5 | 44 | 30 | 27 |
| HNV-06C-34BSP-SP | 20 | G3/4 | G3/4 | 110 | 89 | 55 | 31.4 | 52 | 36 | 34 |
| HNV-08C-1BSP-SP | 25 | G1 | G1 | 132 | 106 | 66 | 37.8 | 62 | 41 | 41 |
| HNV-12C-112BSP-SP | 40 | G1 1/2 | G1 1/2 | 193 | 126 | 126 | 44.5 | 75 | 65 | 65 |
| HNV-16C-2BSP-SP | 50 | G2 | G2 | 219 | 142 | 142 | 63.2 | 105 | 89 | 89 |

IRS 系列 推拉式液压快速接头 IRS Push and pull type Quick Couplings

材料Materials:

母件Coupling: 碳钢镀锌Steel (zinc chromate plating)
插头Nipple: 高性能碳钢, 局部热处理强化
High grade carbon steel with heat treated wear parts

技术特征Features:

符合ISO 7241-1 A系列标准 Interchangeability according to ISO7241-1 part A
双作用套圈, 可以推动连接和拉力拆断。
Double acting sleeve (Push-pull) Can push-connecting or pull-disconnection
多种末端配置, 符合国际标准.如ISO, DN, SAE, BS.
Modular construction, broad choice of end, meets international standard
关键部位经过淬火处理, 持久耐用。
Critical parts are induction hardened for durability
插头和母体采用优质碳钢实心棒料精密加工。
Couplers and nipple are precision machined from solid bar stock
可选配防尘帽。
Dust caps available

互换性Interchange:

派克Parker 200日东 Hydac HP Series Faster CPV-CNV



技术规范SPECIFICATIONS

| 规格(英寸)Body Size(Inch) | 1/4 | 3/8 | 1/2 | 3/4 | 1 |
|--------------------------------|-----------------|-----|-----|-----|-----|
| 额定压力(Mpa)Rate Pressure | 50 | 30 | 30 | 30 | 25 |
| 额定流量(L/Min)Rated Flow | 9 | 30 | 75 | 180 | 270 |
| 温度范围(丁晴)Temperture Range (NBR) | -25°C to +125°C | | | | |

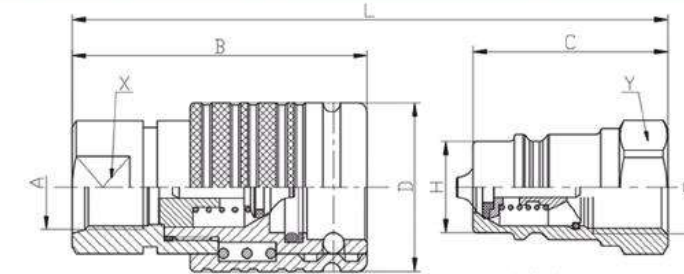
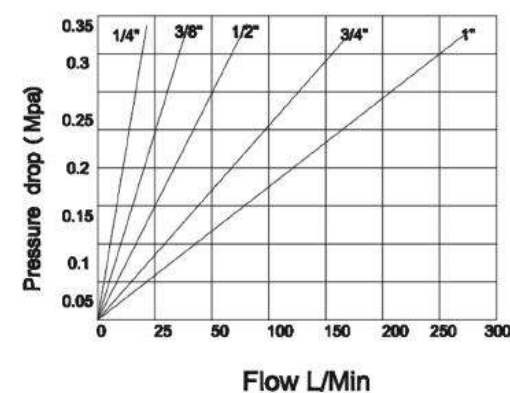

阴接头 Female

阳接头 Male

| PART NO | ISO | A | E | L | B | C | H | D | X | Y |
|------------------|------|------|------|-------|-----|----|------|----|----|----|
| IRS-02C-14BSP-SP | 6.3 | G1/4 | G1/4 | 89.5 | 64 | 44 | 11.8 | 25 | 19 | 19 |
| IRS-03C-38BSP-SP | 10 | G3/8 | G3/8 | 95 | 67 | 51 | 17.2 | 33 | 24 | 22 |
| IRS-04C-12BSP-SP | 12.5 | G1/2 | G1/2 | 99.5 | 71 | 61 | 20.5 | 38 | 27 | 27 |
| IRS-06C-34BSP-SP | 20 | G3/4 | G3/4 | 126.5 | 92 | 65 | 29 | 48 | 34 | 34 |
| IRS-08C-1BSP-SP | 25 | G1 | G1 | 139 | 101 | 72 | 34.3 | 54 | 41 | 41 |

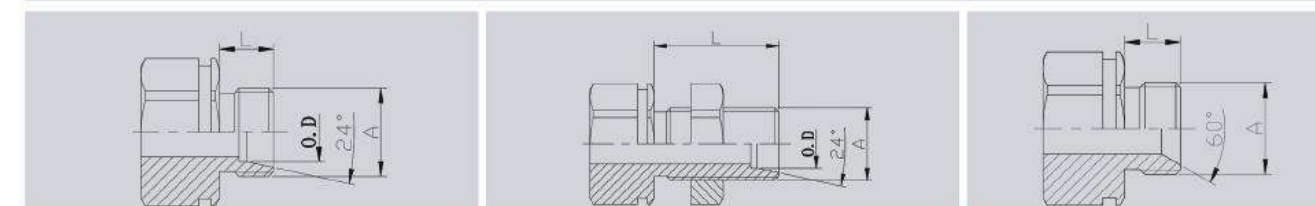

| A | O.D | L | A | O.D | L | A | L |
|---------|-----|----|---------|-----|----|------|----|
| M14X1.5 | L8 | 10 | M14X1.5 | L8 | 26 | G1/4 | 11 |
| N16X1.5 | L10 | 11 | N16X1.5 | L10 | 26 | G3/8 | 12 |
| M18X1.5 | S10 | 12 | M18X1.5 | S10 | 27 | G1/2 | 15 |
| M20X1.5 | S12 | 12 | M20X1.5 | S12 | 27 | G3/4 | 17 |
| M22X1.5 | S14 | 14 | M22X1.5 | S14 | 27 | G1 | 20 |
| M24X1.5 | S16 | 14 | M24X1.5 | S16 | 29 | | |
| M26X1.5 | L18 | 12 | M26X1.5 | L18 | 34 | | |
| M30X2 | S20 | 16 | M30X2 | S20 | 36 | | |
| M36X2 | S25 | 18 | M36X2 | S25 | 49 | | |
| M42X2 | S30 | 20 | | | | | |

NS 系列 NS 钢珠密封式液压快速接头 NS Ball sealing type Quick Couplings

材料Materials:

母件Coupling: 碳钢镀锌Steel (zinc chromate plating)
插头Nipple: 高性能碳钢, 局部热处理强化
High grade carbon steel with heat treated wear parts

技术特征Features:

符合ISO5675系列标准 Interchangeability according to ISO5675
阀采用坚硬的铬合金钢球, 钢球被弹簧加载以使牢固的固定在阀座上。
Hard, chrome alloy balls are used for valving. It be loaded on the valve seat by the springs in rated pressure, 球阀提供坚固可靠的重型液压应用。
employs threaded sleeve locking mechanism, mates with matching, wale shrewd. on the nipple
钢珠与阀体之间, 提供金属对金属密封。
The valve provides a metal-to-metal seal between the ball and a coined seat
阀采用坚硬的铬合金钢球, 钢球被弹簧加载, 以使牢固的固定在阀座上。
Hard chrome alloy balls are used for valving They are spring loaded for posttlve seating of the valve
插头和母体采用优质碳钢实心棒料精密加工, 更持久耐用。
Couplers and nipple are precision machined from solid bar stock



互换性Interchange:

派克Parker 4000 ,Faster NS

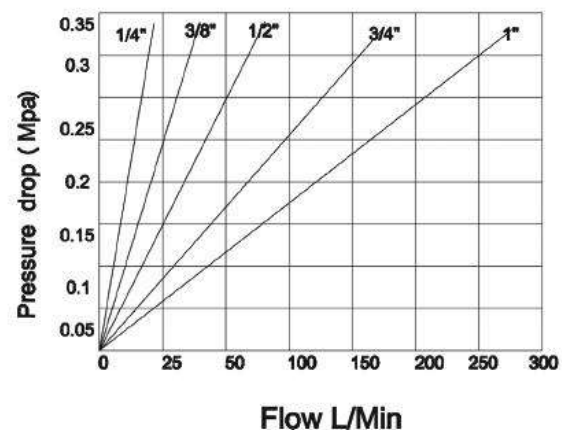

| 技术规范SPECIFICATIONS | | | | | |
|--------------------------------|-------------|-----|-----|-----|-----|
| 规格(英寸)Body Size(Inch) | 1/4 | 3/8 | 1/2 | 3/4 | 1 |
| 额定压力(Mpa)Rate Pressure | 35 | 35 | 30 | 30 | 25 |
| 额定流量(L/Min)Rated Flow | 15 | 30 | 50 | 80 | 140 |
| 温度范围(丁晴)Temperture Range (NBR) | -25℃to+125℃ | | | | |

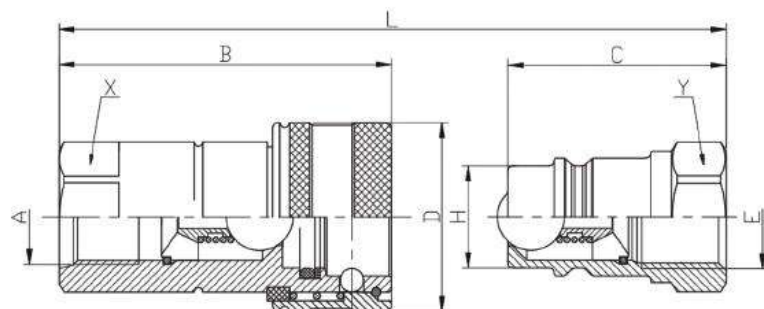

阴接头 Female

阳接头 Male

| PART NO | ISO | A | E | L | B | C | H | D | X | Y |
|-----------------|------|------|------|-----|------|------|------|----|----|----|
| NS-02C-14BSP-SP | 6.3 | G1/4 | G1/4 | 66 | 50 | 33 | 14.2 | 27 | 19 | 19 |
| NS-03C-38BSP-SP | 10 | G3/8 | G3/8 | 78 | 59.5 | 39 | 19 | 33 | 24 | 24 |
| NS-04C-12BSP-SP | 12.5 | G1/2 | G1/2 | 88 | 68 | 46 | 20.5 | 38 | 27 | 27 |
| NS-06C-34BSP-SP | 19 | G3/4 | G3/4 | 107 | 82.5 | 53.5 | 28 | 48 | 34 | 34 |
| NS-08C-1BSP-SP | 25 | G1 | G1 | 132 | 100 | 66 | 31.3 | 56 | 41 | 41 |

3CFPV系列 3CFPV 液压快速接头 3CFPV Hydraulic Quick Couplings

材料Materials:

母件Coupling: 高性能碳钢, 局部热处理 强化
High grade carbon steel with heat treated wear parts

技术特征Features:

符合ISO 7241-1 A系列标准 Interchangeability according to ISO7241-1 part A
在紧急状态下可带压断开。
Disconnexion under pressure only as breakaway
阳接头带压时可连接。
Connectable with male part under pressure
双作用套圈, 可以推动连接和拉力拆卸。
Double acting sleeve (Push-pull) Can push-connecting or pull-disconnection
锥阀组合性密封, 更好保证气密性密封, 并将由于暂速流体所造成的密封性剥蚀和损坏程度降至最低。
Captive valve seal assures poppet sealing The valve seal is positively captured by the metal popet to minimize seal washout or damage from high velocity fluid
关键部位经过淬火处理, 持久耐用。
Critical parts are induction hardened for durability
可选配防尘帽。
Dust caps available

互换性Interchange:

Faster 3CCFPV ,parker 9404 series, DNP PPK3

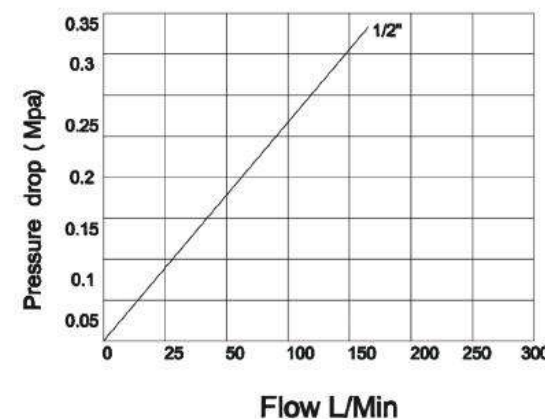

技术规范SPECIFICATIONS

| | |
|--------------------------------|-------------|
| 规格(英寸)Body Size(Inch) | 1/2 |
| 额定压力(Mpa)Rate Pressure | 25 |
| 额定流量(L/Min)Rated Flow | 68 |
| 温度范围(丁晴)Temperture Range (NBR) | -25℃to+125℃ |

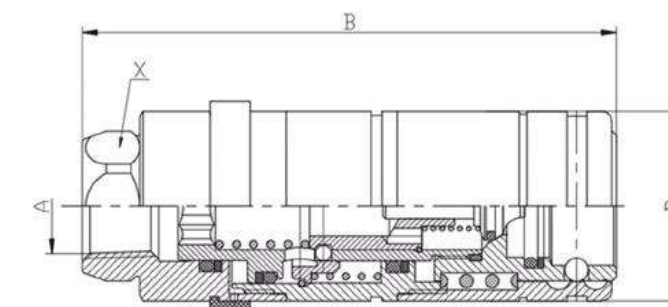

阴接头 Female

| PART NO | ISO | A | D | B | Y |
|--------------------|------|-----------|----|-------|----|
| 3CFPV-04C-12BSP-SP | 12.5 | G1/2 | 38 | 107.3 | 27 |
| 3CFPV-04C-12NPT-SP | 12.5 | 1/2NPT | 38 | 107.3 | 27 |
| 3CFPV-04C-M2215-SP | 12.5 | M22X1.5 | 38 | 107.3 | 32 |
| 3CFPV-04C-34UNF-SP | 12.5 | 3/4-16UNF | 38 | 107.3 | 27 |

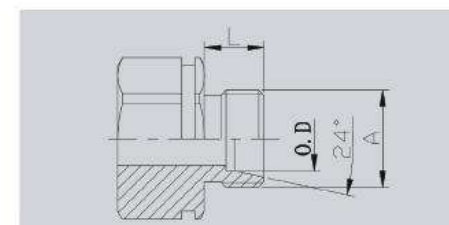

| A | O.D | L |
|---------|-----|----|
| M22X1.5 | L15 | 14 |
| M30X2 | L22 | 16 |

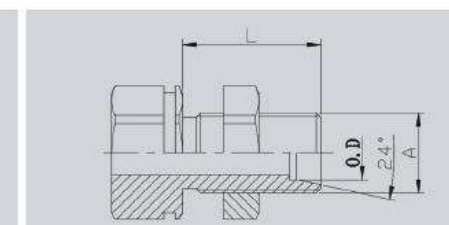

| A | O.D | L |
|---------|-----|----|
| M18X1.5 | L12 | 27 |
| M22X1.5 | L15 | 27 |

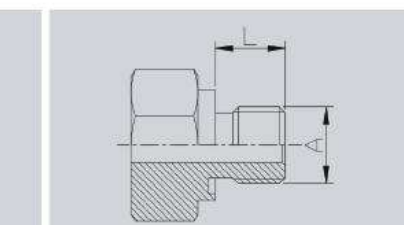

| A | L |
|---------|----|
| G1/2 | 12 |
| M22X1.5 | 12 |

NV系列 NV液压快速接头 NV Hydraulic Quick Couplings

材料Materials:

母件Coupling: 碳钢镀锌Steel (zinc chromate plating)
插头Nipple: 高性能碳钢, 局部热处理强化
High grade carbon steel with heat treated wear parts

技术特征Features:

符合ISO5675系列标准 Interchangeability according to ISO5675
广泛的材料应用, 密封件, 及终端配置, 适合于任何类型的工业应用。
Can be used for any type of industrial applications because of the broad range of materials seals and end configurations
插头和套筒经过淬火处理, 能经受住冲击而造成的机械损坏。
Both sleeve and nipple are hardened to make the couplings resistant to damage from brinelling and mechanical shock
耐用球锁机制确保每次都可靠连接。

The durable-ball-locking mechanism ensures a reliable connection every time
锥阀组合性密封, 更好保证气密性密封, 并将由于高速流体所造成的密封性冲刷和损坏程度降至最低
Captive valve seal assures poppet sealing The valve seal is positively captured by the metal poppet to minimize seal washout or damage from high velocity fluid

互换性Interchange:

派克Parker 4000, Faster NV

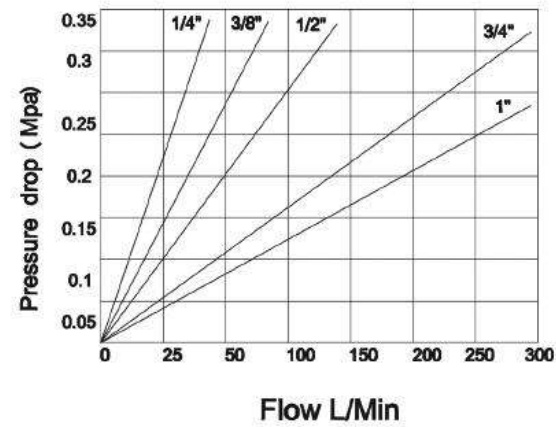

| 技术规范SPECIFICATIONS | | | | | |
|---------------------------------|-----------------|-----|-----|-----|-----|
| 规格(英寸)Body Size(Inch) | 1/4 | 3/8 | 1/2 | 3/4 | 1 |
| 额定压力(Mpa)Rate Pressure | 35 | 30 | 30 | 30 | 25 |
| 额定流量(L/Min)Rated Flow | 15 | 50 | 75 | 150 | 230 |
| 温度范围(丁晴)Temperature Range (NBR) | -25°C to +125°C | | | | |

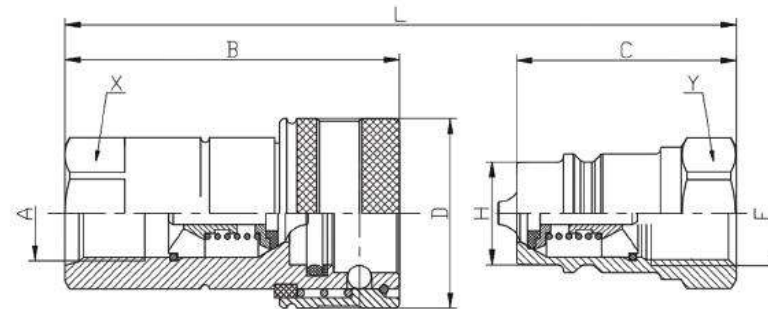

阴接头 Female

阳接头 Male

| PART NO | ISO | A | E | L | B | C | H | D | X | Y |
|-----------------|------|------|------|-----|-----|----|------|----|----|----|
| NV-02C-14BSP-SP | 6.3 | G1/4 | G1/4 | 61 | 50 | 33 | 14.2 | 27 | 19 | 19 |
| NV-03C-38BSP-SP | 10 | G3/8 | G3/8 | 78 | 60 | 39 | 19 | 33 | 24 | 24 |
| NV-04C-12BSP-SP | 12.5 | G1/2 | G1/2 | 88 | 66 | 44 | 20.5 | 38 | 27 | 27 |
| NV-06C-34BSP-SP | 19 | G3/4 | G3/4 | 108 | 83 | 54 | 28 | 48 | 34 | 34 |
| NV-08C-1BSP-SP | 25 | G1 | G1 | 132 | 100 | 66 | 31.3 | 56 | 41 | 41 |

TFH系列 液压快速接头 TFH Hydraulic Quick Couplings

材料Materials:

母件Coupling: 碳钢镀锌Steel (zinc chromate plating)
插头Nipple: 高性能碳钢, 局部热处理强化
High grade carbon steel with heat treated wear parts

技术特征Features:

安全锁定机构, 防止意外断开, 插入既锁定机构, 连接时, 允许单手操作。
A safety sleeve lock prevents accidental disconnection Push-to-connect operation allows one hand operation when connecting the coupling
插头和套筒经过淬火处理, 能经受住冲击而造成的机械损坏。
Both sleeve and nipple are hardened to make the couplings resistant to damage from brinelling and mechanical shock
耐用球锁机制确保每次都可靠连接。

The durable-ball-locking mechanism ensures a reliable connection every time
锥阀组合性密封, 更好保证气密性密封, 并将由于高速流体所造成的密封性冲刷和损坏程度降至最低。

Captive valve seal assures poppet sealing The valve seal is positively captured by the metal poppet to minimize seal washout or damage from high velocity fluid
可在阴阳接头同时带压状态一步连接。
Connectable with male and female under pressure-one step Connexion

互换性Interchange:

天马 TEMA T, CEJN525

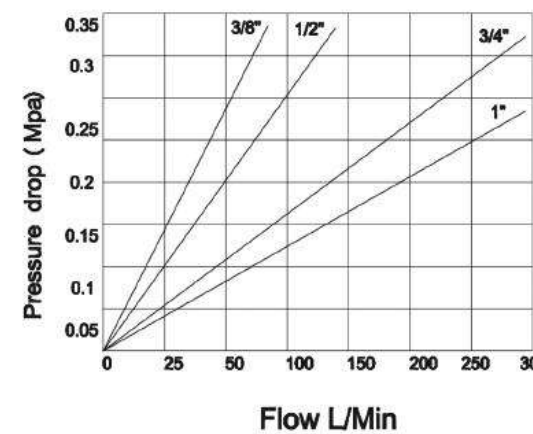

| 技术规范SPECIFICATIONS | | | | |
|---------------------------------|-----------------|-----|-----|-----|
| 规格(英寸)Body Size(Inch) | 3/8 | 1/2 | 3/4 | 1 |
| 额定压力(Mpa)Rate Pressure | 35 | 35 | 28 | 25 |
| 额定流量(L/Min)Rated Flow | 50 | 75 | 180 | 270 |
| 温度范围(丁晴)Temperature Range (NBR) | -25°C to +125°C | | | |

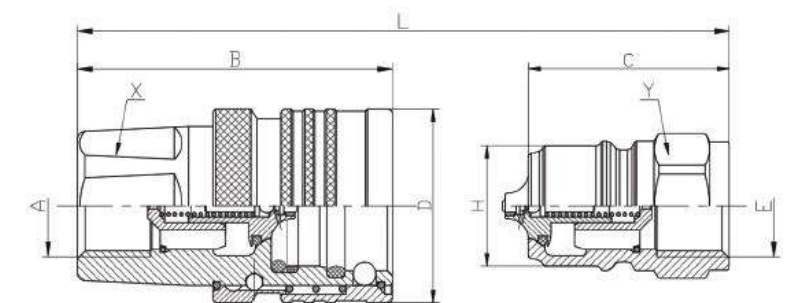

阴接头 Female

阳接头 Male

| PART NO | ISO | A | E | L | B | C | H | D | X | Y |
|------------------|------|------|------|-------|----|------|-------|----|----|----|
| TFH-03C-38BSP-SP | 10 | G3/8 | G3/8 | 74.5 | 60 | 38 | 19.95 | 34 | 24 | 22 |
| TFH-04C-12BSP-SP | 12.5 | G1/2 | G1/2 | 81.5 | 65 | 41.5 | 24.75 | 40 | 30 | 27 |
| TFH-06C-34BSP-SP | 20 | G3/4 | G3/4 | 90 | 73 | 46 | 32.75 | 52 | 38 | 36 |
| TFH-08C-1BSP-SP | 25 | G1 | G1 | 106.5 | 88 | 54 | 40.9 | 62 | 45 | 46 |

V F 系列 VF 液压快速接头 VF Hydraulic Quick Couplings

材料Materials:

母件Coupling: 碳钢镀锌Steel (zinc chromate plating)
插头Nipple: 高性能碳钢, 局部热处理强化 High grade carbon steel with heat treated wear parts

技术特征Features:

符合ISO5676系列标准 Interchangeability according to ISO5676
插头和套圈经过淬火处理, 能经受住冲击而造成的的机械损坏。
Both sleeve and nipple are hardened to make the couplings resistant to damage from brinelling and mechanical shock
耐用球锁机制确保每次都可靠连接。
The durable-ball-locking mechanism ensures a reliable connection every time
平面阀设计, 在连接最小的空气混入, 断开时很少的流体泄漏及容易清洁。
Flush-faced poppet for a minimal air inclusion when connecting, minima fluid loss during disconnection and for an easy cleaning
标准密封圈为丁腈, 其他材料为氟橡胶, 三元乙丙橡胶, 可供选择。
NBR(Nitrile) as standard Other seal materials FKM(VitonTM), EPDM (Ethylene propylene) are available upon request

互换性Interchange:

Faster VF

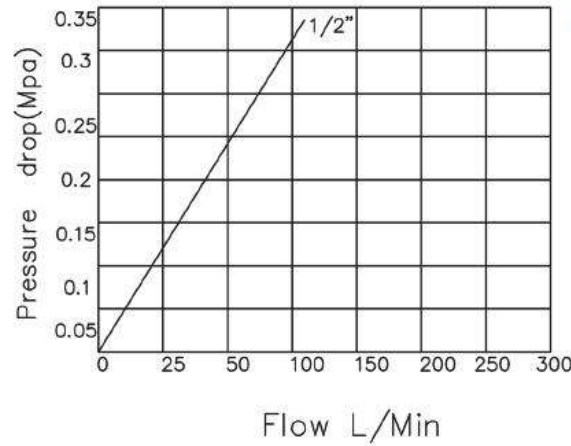

| 技术规范SPECIFICATIONS | |
|---------------------------------|-------------------|
| 规格(英寸)Body Size(Inch) | 1/2 |
| 额定压力(Mpa)Rate Pressure | 25 |
| 额定流量(L/Min)Rated Flow | 50 |
| 温度范围(丁腈)Temperature Range (NBR) | -25 °C to +125 °C |

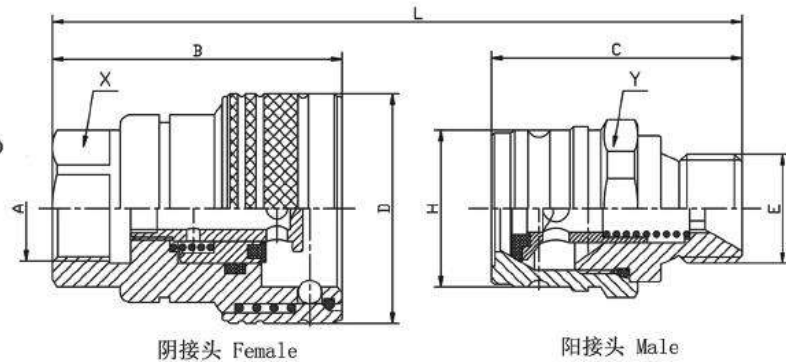

| PART NO | ISO | A | E | L | B | C | H | D | X | Y |
|------------------|-----|---------|------|------|------|----|----|----|----|----|
| HPA-02C-14BSP-SP | 6.3 | M20X1.5 | G1/2 | 88.5 | 55.5 | 48 | 30 | 44 | 27 | 32 |

| A T P | | | A T P | | | A D | |
|---------|-----|----|---------|-----|----|---------|---------|
| M18X1.5 | L12 | 27 | M20X1.5 | S12 | 27 | M16X1.5 | M20X1.5 |
| | | | | | | M18X1.5 | M20X1.5 |

ST 系列 开放式液压快速接头 ST Open Type Hydraulic Quick Couplings

材料Materials:

母件Coupling: 碳钢镀锌Steel (zinc chromate plating)
插头Nipple: 高性能碳钢, 局部热处理强化
High grade carbon steel with heat treated wear parts

技术特征Features:

铜球锁定. Ball locking mechanism
无阀设计, 更大的流通最小阻力。
Non-valved couplers have minimum flow resistance for maximum cooling
插头和母体采用实心棒料精密加工, 更持久耐用。
Couplers and nipple are precision machined from solid bar stock
耐用球锁机制确保每次都可靠连接。
The durable-ball-locking mechanism ensures a reliable connection every time
可选用碳钢, 黄铜, 不锈钢制品。Steel, Brass, Stainless steel are available upon request

互换性Interchange:

派克Parker ST. 汉森Hansen ST Series

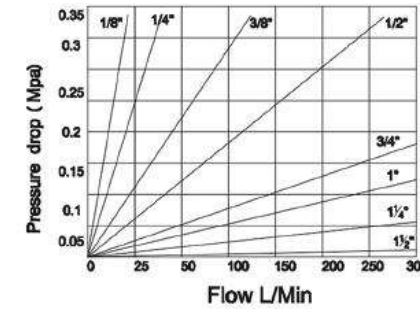

技术规范SPECIFICATIONS

| 规格(英寸)Body Size(Inch) | 1/8 | 1/4 | 3/8 | 1/2 | 3/4 | 1 | 1 1/4 | 1 1/2 |
|---------------------------------|-------------------|-----|------|------|------|-----|-------|-------|
| (Brass)额定压力(Mpa) | 17.5 | 36 | 18.5 | 15 | 12 | 12 | 12 | 9.5 |
| (Steel)额定压力(Mpa) | 38 | 38 | 24 | 18.5 | 18.5 | 14 | 12 | 9.5 |
| (Stainless Steel)额定压力(Mpa) | 35 | 30 | 25 | 21 | 21 | 10 | 10 | 8 |
| 额定流量(L/Min)Rated Flow | 5 | 17 | 50 | 75 | 190 | 270 | 750 | 1600 |
| 温度范围(丁腈)Temperature Range (NBR) | -25 °C to +125 °C | | | | | | | |

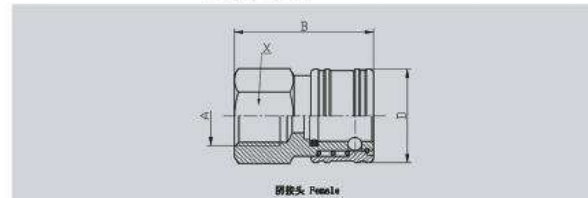

| PART NO | A | D | B | X |
|------------------|--------|------|------|----|
| ST-01C-18BSP-SF | G1/8 | 17.5 | 27 | 14 |
| ST-02C-14BSP-SF | G1/4 | 24 | 39 | 20 |
| ST-03C-38BSP-SF | G3/8 | 29 | 41.5 | 25 |
| ST-04C-12BSP-SF | G1/2 | 33 | 50 | 27 |
| ST-06C-34BSP-SF | G3/4 | 42 | 54.5 | 36 |
| ST-08C-1BSP-SF | G1 | 51 | 61.5 | 44 |
| ST-12C-114BSP-SF | G1 1/4 | 64 | 62 | 50 |
| ST-12C-112BSP-SF | G1 1/2 | 76 | 73 | 64 |

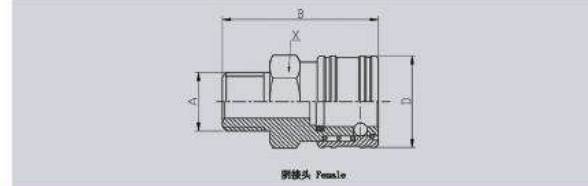

| PART NO | A | D | B | X |
|-----------------|------|------|------|----|
| ST-01C-18BSP-SM | R1/8 | 17.5 | 27 | 14 |
| ST-02C-14BSP-SM | R1/4 | 24 | 43 | 20 |
| ST-03C-38BSP-SM | R3/8 | 29 | 44.5 | 25 |
| ST-04C-12BSP-SM | R1/2 | 33 | 49 | 27 |
| ST-06C-34BSP-SM | R3/4 | 42 | 55 | 36 |
| ST-08C-1BSP-SM | R1 | 51 | 64 | 44 |

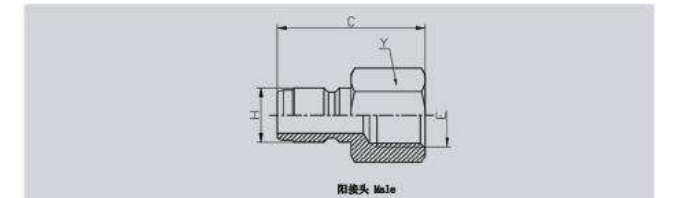

| PART NO | E | H | C | Y |
|------------------|--------|------|------|----|
| ST-01C-18BSP-PF | G1/8 | 7.9 | 24.5 | 14 |
| ST-02C-14BSP-PF | G1/4 | 11.7 | 37 | 20 |
| ST-03C-38BSP-PF | G3/8 | 14.8 | 41.3 | 25 |
| ST-04C-12BSP-PF | G1/2 | 18 | 48.5 | 27 |
| ST-06C-34BSP-PF | G3/4 | 25 | 54.5 | 36 |
| ST-08C-1BSP-PF | G1 | 33.3 | 59.5 | 44 |
| ST-12C-114BSP-PF | G1 1/4 | 41.7 | 60.5 | 50 |
| ST-12C-112BSP-PF | G1 1/2 | 52.9 | 71 | 64 |

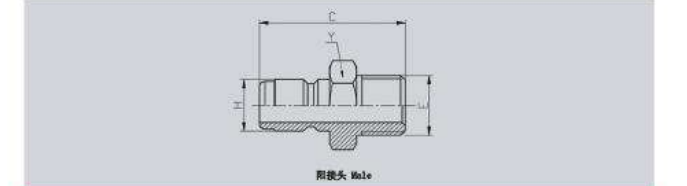

| PART NO | E | H | C | Y |
|-----------------|------|------|------|----|
| ST-01C-18BSP-PM | R1/8 | 7.9 | 26.3 | 11 |
| ST-02C-14BSP-PM | R1/4 | 11.7 | 38.8 | 14 |
| ST-03C-38BSP-PM | R3/8 | 14.8 | 43 | 17 |
| ST-04C-12BSP-PM | R1/2 | 18 | 49 | 22 |
| ST-06C-34BSP-PM | R3/4 | 25 | 55.5 | 27 |
| ST-08C-1BSP-PM | R1 | 33.3 | 63.5 | 36 |

DF系列 DF测试液压快速接头 DF Diagnostic Hydraulic Quick Couplings

材料Materials:

母件Coupling: 碳钢镀锌Steel (zinc chromate plating)
插头Nipple: 高性能碳钢, 局部热处理强化
High grade carbon steel with heat treated wear parts

技术特征Features:

符合SAE J 1502和ISO 15171-1标准。
Nipples meet or exceed SAE J 1502 and ISO 15171-1 design and performance specification Technical features
测试快速接头, 为液压和气动系统提供测试点, 方便于性能设计。
Diagnostic couplings provide easily accessible test points for performance testing of hydraulic and pneumatic systems
安全锁定机构, 防止意外断开, 插入既锁定机构, 连接时, 允许单手操作。
A safety sleeve lock prevents accidental disconnection Push-to-connect operation allows one hand operation when connecting the coupling
平面阀设计, 在连接最小的空气混入, 断开时很少的流体泄漏及容易清洁。
Flush-faced poppet for a minimal air inclusion when connecting, minima fluid loss during disconnection and for an easy cleaning
标准密封圈为丁腈, 其他材料为氟橡胶, 三元乙丙橡胶, 可供选择。
NBR(Nitrile) as standard Other seal materials FKM(VitonTM), EPDM (Ethylene propylene) are available upon request

互换性Interchange:

派克Parker PD Series ,Faster DF



技术规范SPECIFICATIONS

| | |
|--------------------------------|---------------|
| 规格(英寸)Body Size(Inch) | 1/4 |
| 额定压力(Mpa)Rate Pressure | 47 |
| 额定流量(L/Min)Rated Flow | 5 |
| 温度范围(丁腈)Temperture Range (NBR) | -25℃ to +125℃ |

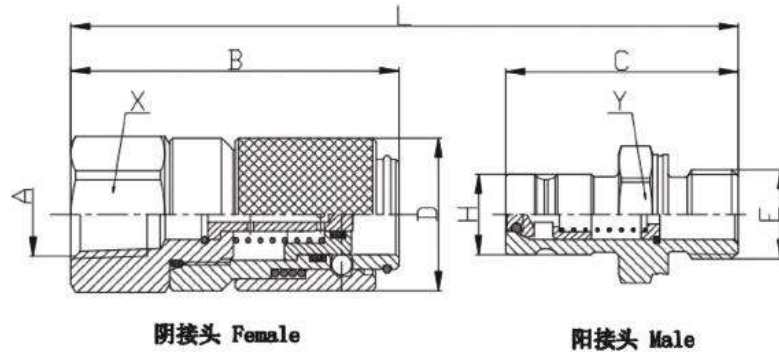
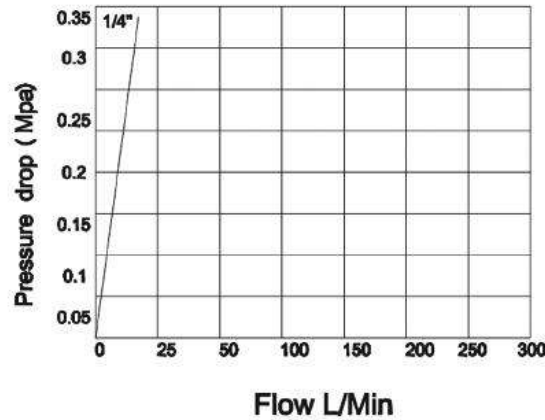

阴接头 Female

阳接头 Male

| PART NO | ISO | A | E | L | B | C | H | D | X | Y |
|------------------|-----|------|------|----|----|----|------|----|----|----|
| HPA-02C-14BSP-SP | 6.3 | G1/4 | G1/4 | 75 | 50 | 40 | 12.7 | 24 | 22 | 19 |

| A | O.D | L | A | L | A | L |
|---------|-----|----|---------|----|---------|----|
| M14X1.5 | L10 | 12 | G1/4 | 12 | G1/4 | 12 |
| M12X1.5 | L8 | 12 | M14X1.5 | 12 | M14X1.5 | 12 |

125系列 125 开闭式超高压液压快速接头 125 Close Type Super High Pressure Hydraulic Quick Couplings

材料Materials:

母件Coupling: 碳钢镀锌Steel (zinc chromate plating)
插头Nipple: 高性能碳钢, 局部热处理强化 High grade carbon steel with heat treated wear parts

技术特征Features:

可靠的阀止档, 阀轴架可保持对中并提供金属对金属的阀止档, 从而确认每次阀都可完全打开。
Positive valve stop, the perch maintains valve alignment and provides metal to metal valve stop to ensure that the valves open fully, every time.
带橡胶密封件的精密加工阀可在断开后提供可靠的关系。
Precision machined valves with electrometric seal provide for positive shut-off upon disconnection.
经过淬火处理的公接头和套筒以及实心料结构造就优质接头, 它可最大的抵抗由于液压和机械冲击而造成的损坏。
Hardened nipples and sleeves and solid barstock construction make for a quality coupling with max-imum resistance to damage from hydraulic and mechanical shock.
耐用球锁机构保证每次都能可靠连接, 更多数量的锁定钢球均匀分配工作负载, 同时提供对中及旋转动作。
Durable ball-locking mechanism assures reliable connection every time. A large number of locking balls distributes and work load evenly while providing alignment and swiveling action to reduce hose torque and prolong hose life. CAUTION: These products are not to be used as swivels; rotation under pressure will result in excessive and premature wear.
作从而减小软管扭曲并延长软管使用期。警告: 这类产品不能用作旋转接头, 在压力下旋转会导致过度或过早磨损。
Sleeve locking mechanism prevents accidental disconnection when coupling is dragged along the ground



互换性Interchange:

CEJN 115 116 125

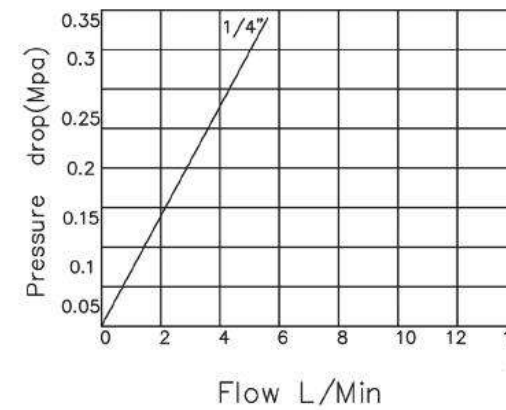

技术规范SPECIFICATIONS

| | |
|--------------------------------|---------------|
| 规格(英寸)Body Size(Inch) | 1/4 |
| 额定压力(Mpa)Rate Pressure | 150 |
| 额定流量(L/Min)Rated Flow | 5.8 |
| 温度范围(丁腈)Temperture Range (NBR) | -25℃ to +125℃ |

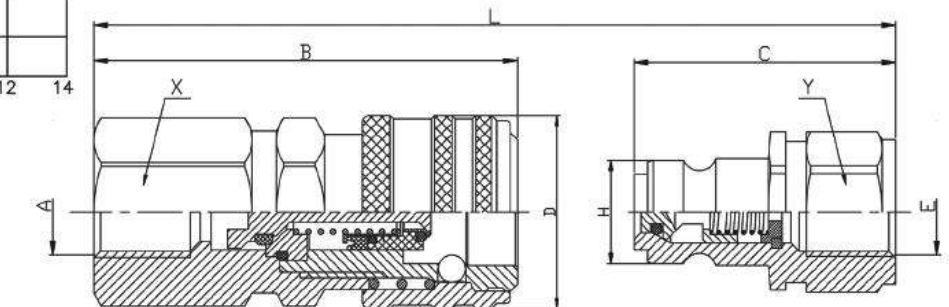

阴接头 Female

阳接头 Male

| PART NO | ISO | A | E | L | B | C | H | D | X | Y |
|------------------|-----|--------|--------|------|------|------|----|----|----|----|
| 125-01C-14BSP-SP | 2.5 | G1/4 | G1/4 | 80.5 | 61.5 | 38 | 15 | 28 | 24 | 22 |
| 125-01C-38BSP-SP | 2.5 | G3/8 | G3/8 | 83.5 | 63 | 39.5 | 15 | 28 | 24 | 24 |
| 125-01C-14NPT-SP | 2.5 | 1/4NPT | 1/4NPT | 80.5 | 61.5 | 38 | 15 | 28 | 24 | 22 |
| 125-01C-38NPT-SP | 2.5 | 3/8NPT | 3/8NPT | 83.5 | 63 | 39.5 | 15 | 28 | 24 | 24 |

HPA系列 HPA螺纹锁紧式快速接头 HPA High Pressure Screw Type Quick Couplings

材料Materials:

母件Coupling: 碳钢镀锌Steel (zinc chromate plating)

插头Nipple: 高性能碳钢, 局部热处理强化 High grade carbon steel with heat treated wear parts

技术特征Features:

符合ISO 14540系列标准 Interchangeability according to ISO14540

采用聚氨酯橡胶材料密封, 以防高压下被挤出

The interface seal is polyurethane which resists high pressure extrusion

阴接头采用螺纹套筒锁紧结构, 与阳接头相应的外螺纹配套使用.

employs threaded sleeve locking mechanism, mates with matching male thread on the nipple

钢珠与阀体之间, 提供金属对金属密封。

The valve provides a metal-to-metal seal between the ball and a coined seat

阀采用坚硬的铬合金钢球, 钢球被弹簧加载, 以使阀牢固的固定在阀座上。

Hard chrome alloy balls are used for valving They are spring loaded for positive seating of the valve

插头和母体采用优质碳钢实心棒料精密加工, 更持久耐用。

Couplers and nipple are precision machined from solid bar stock

互换性Interchange:

派克Parker 3000 ,Faster PVVM

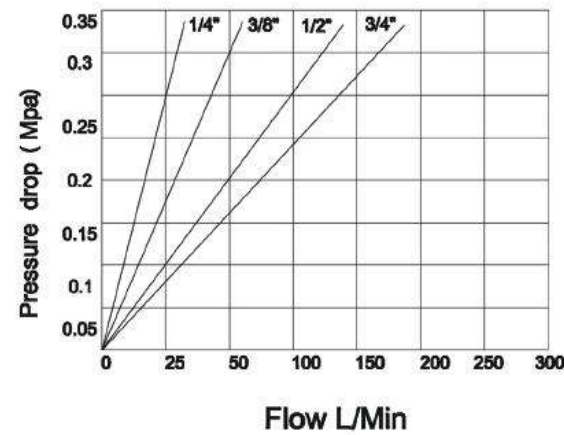

| 技术规范SPECIFICATIONS | | | | |
|--|---------------------|-----|-----|-----|
| 规格(英寸)Body Size(Inch) | 1/4 | 3/8 | 1/2 | 3/4 |
| 额定压力(Mpa)Rate Pressure | 70 | 70 | 50 | 50 |
| 额定流量(L/Min)Rated Flow | 15 | 20 | 45 | 105 |
| 温度范围(聚氨酯)Temperture Range (polyurethane) | - 25 °C to + 125 °C | | | |

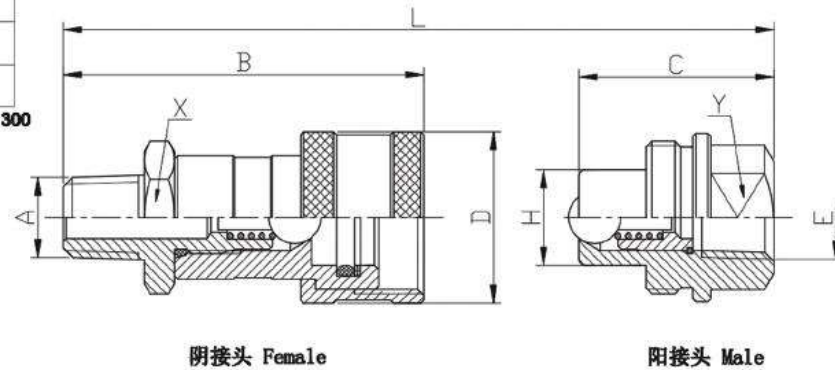

| PART NO | ISO | A | E | L | B | C | H | D | X | Y |
|------------------|------|--------|--------|-------|------|------|------|------|----|----|
| HPA-02C-14NPT-SP | 6.3 | 1/4NPT | 1/4NPT | 74 | 60 | 32.5 | 15.9 | 28.5 | 22 | 19 |
| HPA-03C-38NPT-SP | 10 | 3/8NPT | 3/8NPT | 83 | 72.5 | 35 | 19 | 35 | 24 | 32 |
| HPA-04C-12NPT-SP | 12.5 | 1/2NPT | 1/2NPT | 99.5 | 80 | 47 | 22.1 | 42 | 27 | 27 |
| HPA-06C-34NPT-SP | 19 | 3/4NPT | 3/4NPT | 121.5 | 97.5 | 58 | 29.1 | 52 | 38 | 35 |

AVE系列 AVE螺纹锁紧式快速接头 AVE High Pressure Screw Type Quick Couplings

材料Materials:

母件Coupling: 碳钢镀锌Steel (zinc chromate plating)

插头Nipple: 高性能碳钢, 局部热处理强化

High grade carbon steel with heat treated wear parts

技术特征Features:

符合ISO 14541系列标准 Interchangeability according to ISO14541重型标准设计.

Heavy-duty design as standard

O形圈额外提供PTFE支撑环, 应用于髙压力环境.

阳接头采用螺纹套筒锁紧结构, 与阴接头相应的外螺纹配套使用.

employs threaded nipple locking mechanism mates with matching male threads on the sleeve

模块化末端配置, 多种尾端选择. Modular construction, broad choice of end configurations

能在压力为达到5MPa下连接. Connect with pressure up to 5 Mpa is possible

互换性Interchange:

派克Parker QPHA ,Faster CVV

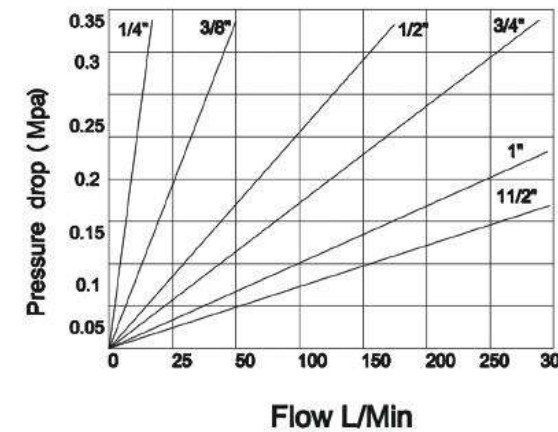

| 技术规范SPECIFICATIONS | | | | | | |
|--------------------------------|---------------------|-----|-----|-----|-----|-------|
| 规格(英寸)Body Size(Inch) | 1/4 | 3/8 | 1/2 | 3/4 | 1 | 1 1/2 |
| 额定压力(Mpa)Rate Pressure | 50 | 40 | 40 | 35 | 35 | 35 |
| 额定流量(L/Min)Rated Flow | 13 | 25 | 75 | 135 | 250 | 450 |
| 温度范围(丁腈)Temperture Range (NBR) | - 25 °C to + 125 °C | | | | | |

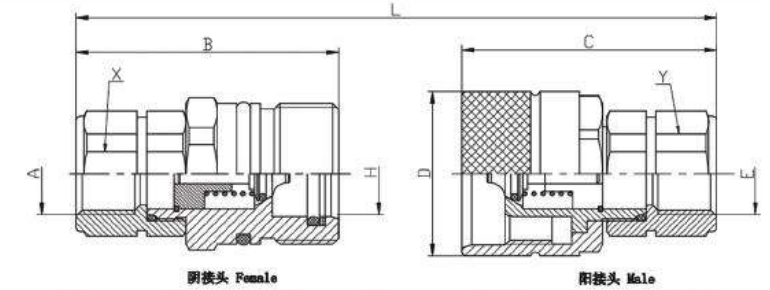

| PART NO | ISO | A | E | L | B | C | H | D | X | Y |
|-------------------|------|--------|--------|-----|------|------|------|----|----|----|
| AVE-02C-14BSP-SP | 6.3 | G1/4 | G1/4 | 94 | 61 | 56.5 | 13.1 | 30 | 19 | 19 |
| AVE-03C-38BSP-SP | 10 | G3/8 | G3/8 | 98 | 64 | 59 | 17.6 | 34 | 22 | 22 |
| AVE-04C-12BSP-SP | 12.5 | G1/2 | G1/2 | 109 | 69.5 | 66.5 | 22 | 42 | 27 | 27 |
| AVE-06C-34BSP-SP | 20 | G3/4 | G3/4 | 132 | 86 | 78 | 28.1 | 48 | 36 | 36 |
| AVE-08C-1BSP-SP | 25 | G1 | G1 | 152 | 100 | 89.5 | 35 | 55 | 41 | 41 |
| AVE-12C-112BSP-SP | 40 | G1 1/2 | G1 1/2 | 196 | 126 | 120 | 54 | 80 | 65 | 65 |

| A | | | A | | | A | |
|---------|-----|----|---------|-----|----|--------|----|
| O.D | L | | O.D | L | | | |
| M14X1.5 | L8 | 10 | M14X1.5 | L8 | 26 | G1/4 | 11 |
| N16X1.5 | L10 | 11 | N16X1.5 | L10 | 26 | G3/8 | 12 |
| M18X1.5 | S10 | 12 | M18X1.5 | S10 | 27 | G1/2 | 15 |
| M20X1.5 | S12 | 12 | M20X1.5 | S12 | 27 | G3/4 | 17 |
| M22X1.5 | S14 | 14 | M22X1.5 | S14 | 27 | G1 | 20 |
| M24X1.5 | S16 | 14 | M24X1.5 | S16 | 29 | G1 1/4 | 25 |
| M26X1.5 | L18 | 12 | M26X1.5 | L18 | 34 | G1 1/2 | 25 |
| M30X2 | S20 | 16 | M30X2 | S20 | 36 | | |
| M36X2 | S25 | 18 | M36X2 | S25 | 38 | | |
| M42X2 | S30 | 20 | M42X2 | S30 | 40 | | |
| M52X2 | S38 | 20 | M52X2 | S38 | 40 | | |

TGW 系列 TGW 螺纹锁紧式快速接头 TGW High Pressure Screw Type Quick Couplings

材料Materials:

母件Coupling:碳钢镀锌Steel (zinc chromate plating)
插头Nipple:高性能碳钢, 局部热处理强化 High grade carbon steel with heat treated wear parts

技术特征Features:

重型标准设计.
Heavy-duty design as standard
O形圈额外提供PTFE支撑环,应用于髙压力环境.
O-ring and PTFE back-up ring to withstand flow surges
阴接头采用螺纹套筒锁紧结构, 与阳接头相应的外螺纹配套使用.
employs threaded sleeve locking mechanism, mates with matching wale shrewd. on the nipple
插头和母体采用优质碳钢实心棒料精密加工,更持久耐用.
Couplers and nipple are precision machined from solid bar stock
能在压力为达到5MPa下连接.
Connect with pressure up to 5 MPa is possible

互换性Interchange:

GROMELLE 6000 Series, HOLMBURY TGW Series

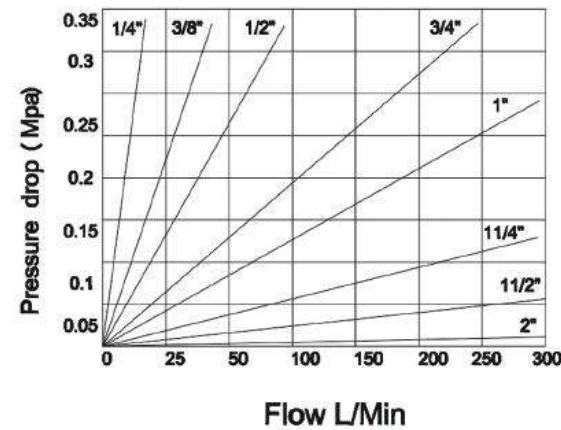

| 技术规范SPECIFICATIONS | | | | | | | | |
|--------------------------------|-----------------|-----|------|-----|-----|-------|-------|-----|
| 规格(英寸)Body Size(Inch) | 1/4 | 3/8 | 1/2 | 3/4 | 1 | 1 1/4 | 1 1/2 | 2 |
| 额定压力(Mpa)Rate Pressure | 95 | 75 | 75 | 65 | 45 | 45 | 30 | 30 |
| 额定流量(L/Min)Rated Flow | 11.5 | 23 | 45.5 | 106 | 190 | 450 | 830 | 900 |
| 温度范围(丁嘴)Temperture Range (NBR) | -25°C to +125°C | | | | | | | |

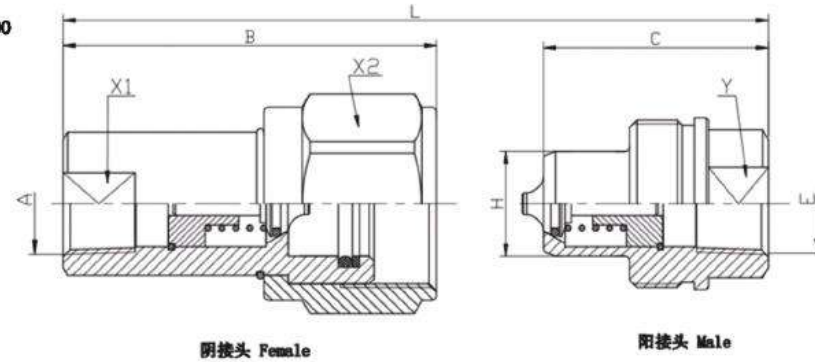

| PART NO | ISO | A | E | L | B | C | H | X1 | X2 | Y |
|-------------------|------|--------|--------|-----|-------|-----|-------|----|-----|----|
| TGW-02C-14BSP-SP | 6.3 | G1/4 | G1/4 | 68 | 58 | 34 | 14.9 | 19 | 32 | 19 |
| TGW-03C-38BSP-SP | 10 | G3/8 | G3/8 | 86 | 71.5 | 41 | 18.95 | 22 | 34 | 22 |
| TGW-04C-12BSP-SP | 12.5 | G1/2 | G1/2 | 94 | 74.5 | 47 | 22 | 27 | 41 | 27 |
| TGW-06C-34BSP-SP | 20 | G3/4 | G3/4 | 114 | 90.5 | 57 | 28.95 | 35 | 50 | 35 |
| TGW-08C-1BSP-SP | 25 | G1 | G1 | 128 | 103.5 | 64 | 36 | 41 | 65 | 41 |
| TGW-10C-114BSP-SP | 32 | G1 1/4 | G1 1/4 | 150 | 130.5 | 75 | 49.8 | 58 | 80 | 58 |
| TGW-12C-112BSP-SP | 40 | G1 1/2 | G1 1/2 | 162 | 141 | 81 | 55 | 61 | 85 | 61 |
| TGW-16C-2BSP-SP | 50 | G2 | G2 | 236 | 205 | 129 | 69.4 | 71 | 105 | 71 |

VVS 系列 螺纹锁紧式快速接头 VVS High Pressure Screw Type Quick Couplings

材料Materials:

母件Coupling:碳钢镀锌Steel (zinc chromate plating)
插头Nipple:高性能碳钢, 局部热处理强化 High grade carbon steel with heat treated wear parts

技术特征Features:

重型标准设计.
Heavy-duty design as standard
O形圈额外提供PTFE支撑环,应用于髙压力环境.
O-ring and PTFE back-up ring to withstand flow surges
阴接头采用螺纹套筒锁紧结构, 与阳接头相应的外螺纹配套使用.
employs threaded sleeve locking mechanism, mates with matching wale shrewd. on the nipple
锥阀组合性密封,更好保证气密性密封, 并将由于髙速流体所造成的密封性剥蚀和损坏程度降至最低.
Captive valve seal assures poppet sealing The valve seal is positively captured by the metal popet to minimize seal washout or damage from high velocity fluid
能在压力为达到5MPa下连接.
Connect with pressure up to 5 MPa is possible

互换性Interchange:

FASTER VVS Series

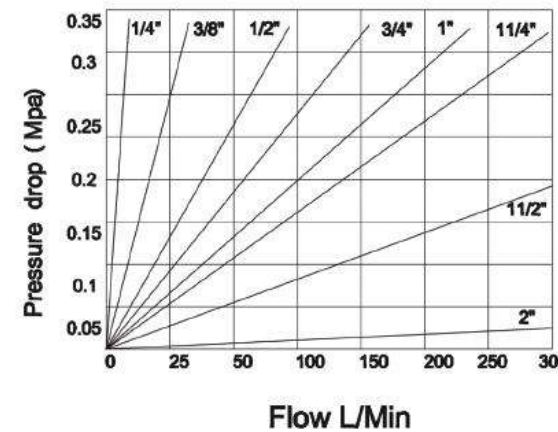

| 技术规范SPECIFICATIONS | | | | | | | | |
|--------------------------------|-----------------|-----|-----|-----|-----|-------|-------|------|
| 规格(英寸)Body Size(Inch) | 1/4 | 3/8 | 1/2 | 3/4 | 1 | 1 1/4 | 1 1/2 | 2 |
| 额定压力(Mpa)Rate Pressure | 80 | 80 | 73 | 73 | 63 | 60 | 40 | 35 |
| 额定流量(L/Min)Rated Flow | 8 | 18 | 40 | 55 | 100 | 140 | 300 | 1000 |
| 温度范围(丁嘴)Temperture Range (NBR) | -25°C to +125°C | | | | | | | |

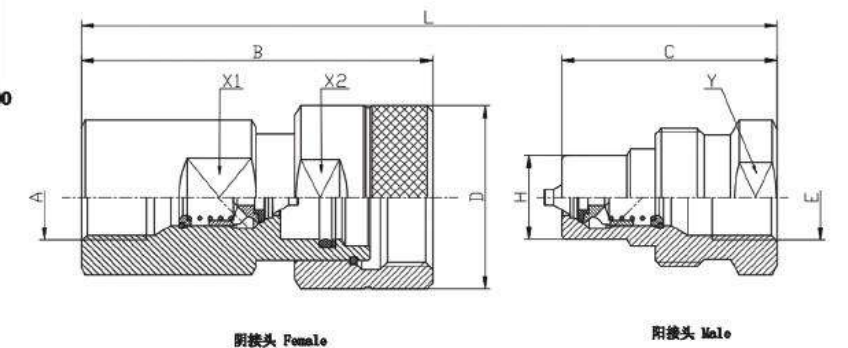

| PART NO | ISO | A | E | L | B | C | H | X1 | X2 | Y |
|-------------------|------|--------|--------|-----|-----|-----|------|-----|-----|-----|
| VVS-02C-14BSP-SP | 6.3 | G1/4 | G1/4 | 84 | 68 | 43 | 14.1 | 22 | 27 | 25 |
| VVS-03C-38BSP-SP | 10 | G3/8 | G3/8 | 90 | 76 | 48 | 18.9 | 30 | 36 | 32 |
| VVS-04C-12BSP-SP | 12.5 | G1/2 | G1/2 | 102 | 87 | 53 | 20.5 | 34 | 41 | 34 |
| VVS-06C-34BSP-SP | 20 | G3/4 | G3/4 | 121 | 106 | 63 | 27.9 | 41 | 50 | 46 |
| VVS-08C-1BSP-SP | 25 | G1 | G1 | 139 | 124 | 72 | 31.3 | 50 | 55 | 50 |
| VVS-10C-114BSP-SP | 32 | G1 1/4 | G1 1/4 | 167 | 153 | 86 | 43.9 | 65 | 75 | 65 |
| VVS-12C-112BSP-SP | 40 | G1 1/2 | G1 1/2 | 188 | 172 | 95 | 53.4 | 75 | 90 | 80 |
| VVS-16C-2BSP-SP | 50 | G2 | G2 | 227 | 207 | 118 | 81.9 | 100 | 125 | 110 |

FB 系列 螺纹锁紧式快速接头 FB High Pressure Screw Type Quick Couplings

材料Materials:

母件Coupling:黑铜Brass(yellow pickled)
插头Nipple:黑铜Brass(yellow pickled)

技术特征Features:

重型标准设计。
Heavy-duty design as standard
重型翼型螺母装配牢固, 特别能经受住通常用于上紧或松开接头的锤子敲击。
Heavy-duty wing nut is ruggedly built specifically to withstand the hammer blows commonly used to tighten and loosen thin coupler.
组合阀密封件使接头可以在满压力下连接及断开, 而不会造成密封件被冲蚀。
Assembled valve seal can permits full pressure connect and disconnect, without seal washout
平齐端面阀机构将夹气及溢流保持在最小值。
The flush face valve keeps air inclusion and spillage to a minimum
抗腐蚀黑铜材质使接头可与大范围的介质兼容并提供。
Corrosion resistant brass coupling, makes it compatible with a widely range and provides widely functionality

互换性Interchange:

Parker 6100 Series, FASTER FB Series
HANSEN 96 Series, AEROQUIP 5100 Series



VCR 系列 螺纹锁紧式快速接头 VCR High Pressure Screw Type Quick Couplings

材料Materials:

母件Coupling:碳钢镀锌Steel (zinc chromate plating)
插头Nipple:高性能碳钢, 局部热处理强化
High grade carbon steel with heat treated wear parts

技术特征Features:

重型标准设计。
Heavy-duty design as standard
重型翼型螺母装配牢固, 特别能经受住通常用于上紧或松开接头的锤子敲击。
Heavy-duty wing nut is ruggedly built specifically to withstand the hammer blows commonly used to tighten and loosen thin coupler.
组合阀密封件使接头可以在满压力下连接及断开, 而不会造成密封件被冲蚀。
Assembled valve seal can permits full pressure connect and disconnect, without seal washout
能在压力为达到5MPa下连接。
Connect with pressure up to 5 MPa is possible

互换性Interchange:

HOLMBURY CVE Series, FASTER VCE Series

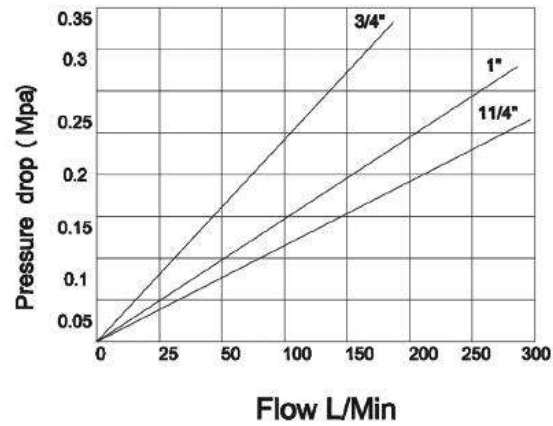

| 技术规范SPECIFICATIONS | | | |
|--------------------------------|---------------|-----|-------|
| 规格(英寸)Body Size(Inch) | 3/4 | 1 | 1 1/4 |
| 额定压力(Mpa)Rate Pressure | 25 | 23 | 21 |
| 额定流量(L/Min)Rated Flow | 62 | 160 | 220 |
| 温度范围(丁晴)Temperture Range (NBR) | -25°Cto+125°C | | |

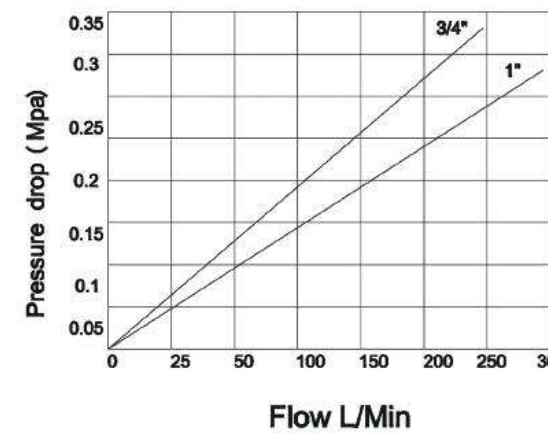
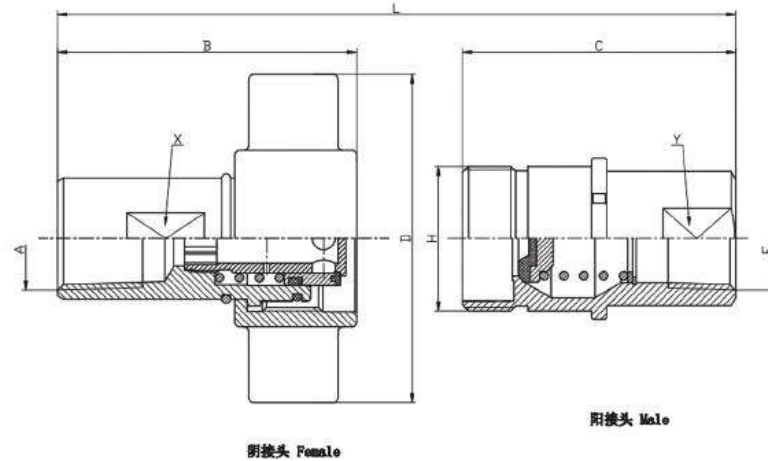

| 技术规范SPECIFICATIONS | | |
|--------------------------------|---------------|-----|
| 规格(英寸)Body Size(Inch) | 3/4 | 1 |
| 额定压力(Mpa)Rate Pressure | 36 | 30 |
| 额定流量(L/Min)Rated Flow | 120 | 160 |
| 温度范围(丁晴)Temperture Range (NBR) | -25°Cto+125°C | |

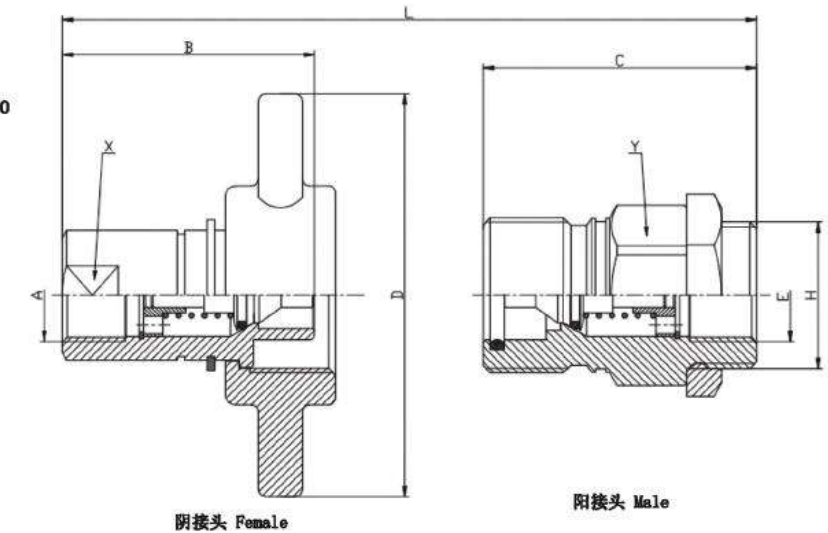

| PART NO | ISO | A | E | L | B | C | D | H | X | Y |
|------------------|-----|----------|----------|-------|------|-------|-----|-------------|----|------|
| FB-06C-34NPT-SP | 15 | 3/4NPT | 3/4NPT | 133.5 | 88 | 66 | 106 | 1 1/2-12UNF | 29 | 33.5 |
| FB-08C-1NPT-SP | 20 | 1NPT | 1NPT | 157 | 98.5 | 83.5 | 110 | 1 7/8-12UNF | 36 | 39.5 |
| FB-10C-114NPT-SP | 25 | 1 1/4NPT | 1 1/4NPT | 164 | 106 | 89 | 132 | 2 1/8-12UNF | 45 | 48 |
| FB-12T-112NPT-SP | 40 | 1 1/2NPT | 1 1/2NPT | 166 | 103 | 104.5 | 134 | 2 1/2-12UN | 51 | 57 |

| PART NO | ISO | A | E | L | B | C | D | H | X | Y |
|-----------------|------|------|------|-----|----|----|-----|----------|----|----|
| FB-06C-34BSP-SP | 16.2 | G3/4 | G3/4 | 132 | 78 | 78 | 114 | 1 1/4BSP | 33 | 46 |
| FB-08C-1BSP-SP | 18.6 | G1 | G1 | 145 | 82 | 83 | 114 | 1 1/4BSP | 40 | 55 |

SVQ系列 螺纹锁紧式快速接头 SVQ High Pressure Screw Type Quick Couplings

材料Materials:

母件Coupling:碳钢镀锌Steel (zinc chromate plating)
插头Nipple:高性能碳钢, 局部热处理强化
High grade carbon steel with heat treated wear parts

技术特征Features:

重型标准设计。
Heavy-duty design as standard
O形圈额外提供PTFE支撑环,应用于髙压力环境。
O-ring and PTFE back-up ring to withstand flow surges
阴接头采用螺纹套筒锁紧结构, 与阳接头相应的外螺纹配套使用。
employs threaded sleeve locking mechanism, mates with matching male thread on the nipple
平齐端面阀机构将夹气及溢流保持在最小值。
The flush face valve keeps air inclusion and spillage to a minimum
能在压力为达到2MPa下连接。
Connect with pressure up to 5 MPa is possible

互换性Interchange:

HANSA RS Series
STAUFF SVQ Series

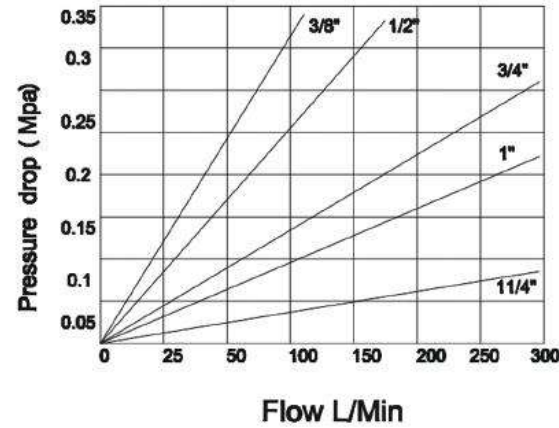

| 技术规范SPECIFICATIONS | | | | | |
|--------------------------------|---------------|-----|-----|-----|-------|
| 规格(英寸)Body Size(Inch) | 3/8 | 1/2 | 3/4 | 1 | 1 1/4 |
| 额定压力(Mpa)Rate Pressure | 42 | 42 | 35 | 35 | 35 |
| 额定流量(L/Min)Rated Flow | 38 | 65 | 180 | 270 | 540 |
| 温度范围(丁晴)Temperture Range (NBR) | -25°Cto+125°C | | | | |

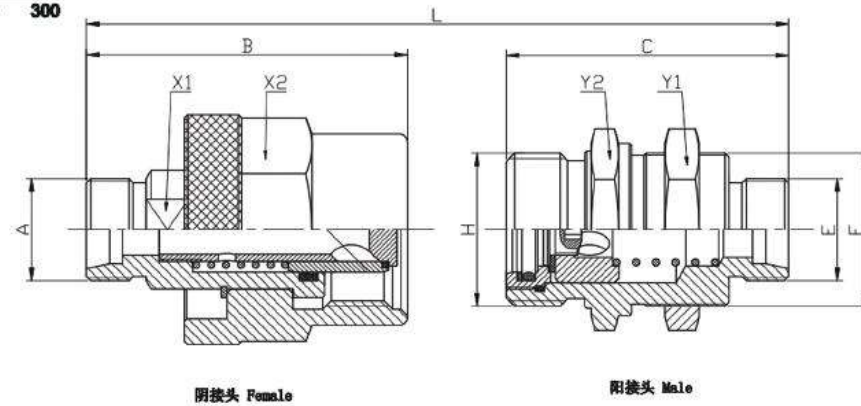

| PART NO | ISO | A | E | L | B | C | H | F | X 1 | X 2 | Y 1 | Y 2 |
|------------------|------|---------|---------|-------|-----|-----|-------|---------|-----|-----|-----|-----|
| SVQ-03C-M1415-SP | 10 | M14X1.5 | M14X1.5 | 103.5 | 50 | 54 | M32X3 | M30X1 | 22 | 32 | 36 | 36 |
| SVQ-04C-M2215-SP | 12.5 | M22X1.5 | M22X1.5 | 119 | 65 | 79 | M36X3 | M36X1 | 46 | 24 | 41 | 41 |
| SVQ-06C-M2615-SP | 16 | M26X1.5 | M26X1.5 | 140 | 77 | 75 | M48X3 | M45X1.5 | 32 | 60 | 50 | 55 |
| SVQ-08C-M362-SP | 20 | M36X2 | M36X2 | 144 | 101 | 87 | M54X3 | M54X1.5 | 41 | 55 | 60 | 55 |
| SVQ-10C-M452-SP | 25 | M45X2 | M45X2 | 227 | 136 | 122 | M79X3 | M80X2 | 55 | 80 | 90 | 85 |

VEP系列 VEP平面螺纹锁紧式液压快速接头 VEP Flat Face Thread Locked Type Hydraulic Quick Couplings

材料Materials:

母件Coupling:碳钢镀锌Steel (zinc chromate plating)
插头Nipple:高性能碳钢, 局部热处理强化 High grade carbon steel with heat treated wear parts

技术特征Features:

新型阀的设计,能抵抗髙速流体与脉冲压力的冲击,提供更髙的性能。
New valve design,it can resistance damage form high flow and the pressure of impulse that providing advanced performance
公头设计带压操作,使其在内部残余髙压下也能实现带压连接。
Special nipple design for connecting under pressure,allows Connection and disconnection with high residual pressures.
VEP系列阴接头上采用螺纹套筒锁紧机构,与公接头上的相应外螺纹配套使用,连接时公母两部分必须通过螺纹采用手动方式结合在一起。
VEP series employs a threaded sleeve locking mechanism, mates with matching male threads on the coupler. The two halves must be manually threaded together from connection.
VEP系列接头在连接及断开时使用平齐端面阀机构操作。这意味着阀之间的接合能使断开时只损失少量流体,或再重新连接使之混入少量空气。
VEP series couplings employ flush valving when connecting or disconnecting.This means only small amounts of fluid can be lost during disconnecting or air inclusion during reconnection
可选配防尘帽及多种螺纹可供选择。
Dust caps available, Female pipe and BSPP or NPT tread are available upon request



互换性Interchange:

意图奇 STUCCHI VEP Series

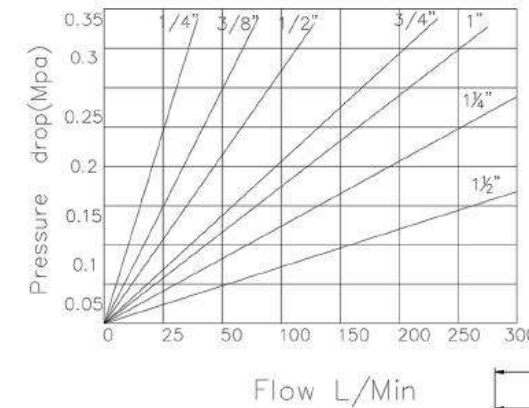

| 技术规范SPECIFICATIONS | | | | | |
|--|---------------------|-----|-----|-------|-------|
| 规格(英寸)Body Size(Inch) | 1/2 | 3/4 | 1 | 1 1/4 | 1 1/2 |
| 额定压力(Mpa)Rate Pressure | 50 | 50 | 50 | 40 | 35 |
| 额定流量(L/Min)Rated Flow | 50 | 90 | 125 | 185 | 370 |
| 温度范围(聚氨酯)Temperture Range (polyurethane) | - 25 °C to + 125 °C | | | | |

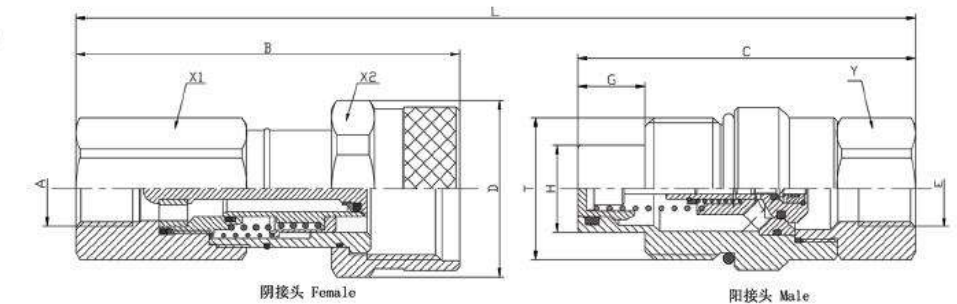

| PART NO | ISO | A | E | L | B | C | D | H | T | G | X 1 | X 2 | Y |
|-------------------|------|--------|--------|-------|-------|-------|------|------|--------|------|-----|-----|----|
| VEP-04C-12BSP-SP | 12.5 | G1/2 | G1/2 | 154.5 | 103.5 | 95 | 49 | 24.5 | M40X3 | 18.8 | 36 | 46 | 36 |
| VEP-06C-34BSP-SP | 16 | G3/4 | G3/4 | 164.3 | 114 | 98.8 | 53.7 | 27 | M45X3 | 19.5 | 41 | 50 | 41 |
| VEP-08C-1BSP-SP | 19 | G1 | G1 | 189.4 | 133.5 | 113.9 | 58.8 | 30 | M50X3 | 24 | 46 | 55 | 46 |
| VEP-10C-114BSP-SP | 25 | G1 1/4 | G1 1/4 | 207.2 | 145.2 | 123.5 | 68.7 | 36 | M58X3 | 24.8 | 55 | 65 | 55 |
| VEP-12C-112BSP-SP | 32 | G1 1/2 | G1 1/2 | 263.5 | 187.5 | 150 | 92 | 57 | Tr80X4 | 31.5 | 65 | 85 | 65 |

4BD4FH模块阀系列 Modular Valve Series

互换性标准 Interchangeability Standard: ISO16028



主要应用 Main Applications:

- ※ 滑移装载机 Skid Steer
- ※ 挖掘机 Excavator
- ※ 移动工程机械 Mobile construction equipment

4BD4FH模块阀系列是为满足现代移动设备的实际需要而开发的最新产品，通过“锦东”在液压连接领域多年的经验面总结出的应对复杂问题的解决方案。根据市场的反应和主要OEM客户的合作设计此款产品。模块阀拥有释放残压系统，允许在带残存压力情况下对接和拆卸，公母接头都允许带残压。配备符合ISO16028互换性的平面式快速接头，模块阀拥有模块化结构和可变化的设计，可提供尺寸为：1/2 (04)，3/4 (08)

4BD4FH modular valve series is the latest Jindong Innovation designed to meet the requirements of the mobile equipment market. Designed with the feedback from the market and with the major OEM collaboration, it has a residual pressure relief system which allows an operator to connect and disconnect the two circuit lines with residual pressure, both in the male and in the female. 4BD4FH modular valve series is equipped with ISO 16028 interchangeable flat face couplings, has a modular design for multiple port options, and allows for a wide range of coupler sizes: 1/2 (04), 3/4 (08)

4BD4FH 模块阀系列 Modular Valve Series

技术性能和选项

快速接头的互锁性：配备ISO16028快速接头，提供不同尺寸及规格。
快速接头类型：平面密封
锁紧机构：钢珠锁紧
对接系统：推入式连接
拆卸系统：拉下母接头的外套
带压对接：用拉杆泄压之后对接
带压拆卸：用拉杆泄压之后拆卸
密封材料：标准NBR（丁腈橡胶）
防挤出挡圈：PTFE（聚四氟乙烯）

TECHNICAL FEATURES AND OPTIONS

Interchangeability: equipped with ISO 16028 couplings available in different configuration and different dimensions
Couplings type: Flat face
Mechanical connection: Locking balls
Connection system: Push to connect
Disconnection system: Pulling back the sleeve of the female coupling
Connection with residual pressure: After draining the pressure with the lever
Disconnection with residual pressure: After draining the pressure with the lever
Seals: standard in NBR (Nitrile)
Anti-extrusion rings: PTFE



优点

操作简便的泄压系统，可以在带有残余压力的情形下轻松对接或拆卸。
在对接或拆卸之前，先要泄掉残压，对接或拆卸时已经没有任何压力，安全，不费力，以减少受伤的风险。
平面容易清洁，帮助减少杂物进入液压回路的污染。
对接或拆卸时液压油损失极少，减少对环境的污染。
对接或拆卸时带入空气极少，增强液压系统功能。
拥有专利的内部阀门设计，压降小，保持回路效率良好的脉冲耐受性。
紧凑精巧和灵活（允许使用不同规格的快速接头）、使用安全简单。

Benefits

User friendly relief system allows for easy connection and disconnection with residual pressure.
It drain the residual pressure before connection and disconnection, allowing the connection without pressure and without effort in safety condition, in order to reduce injury risk.
Flat face is easy to clean, helping to reduce the inclusion of contamination to the hydraulic circuit.
Minimal fluid loss during connection/disconnection, enhancing loss to the environment.
Minimal air inclusion during connection/disconnection, enhancing correct function of the circuit.
Patented internal coupling is valve design creates minimal pressure drop, maintaining circuit efficiency in the system.
Good resistance at impulse pressures.
Compact slim and flexible design (it allow to use different size of couplings).
Safe and simple to use.

P5065多路快速接头组合板系列 P5065 Multicouplings Series

互换性标准 Interchangeability Standard: 锦东内部标准Jindong Internal Standard



主要应用 Main Applications:

- ※ 农业设备 Agricultural equipment
- ※ 移动式工程设备 Mobile construction equipment
- ※ 车辆 Vehicles
- ※ 工业设备 Industrial equipment

P5065系列是结构紧凑的手动式多路快速接头组合板，提供了需要几路液压回路同时拆断或连接的广泛解决方案。最多可用6路1/2，快速接头安全地同时拆断或对接，动作简单，快捷高效，根据应用需要，各路尺寸可相同或不同。

P5065 have a compact structure, manual multi-couplings that offer a wide range of solutions for any application requiring connection and disconnection of several hydraulic. Up to 6 lines 1/2, can be simultaneously connected and disconnected by a safe, simple and quick movement requiring low effort. The lines can all have the same size or each line can be different from the others according to the application.

P5065多路快速接头组合板系列 P5065 Multicouplings Series

技术性能及选项

- 互换性标准：锦东内部标准
- 机械连接：内部凸轮和锁销
- 对接系统：旋转拉杆
- 拆断系统：旋转拉杆
- 材质和表面处理：
- 安装板：铝合金氧化
- 凸轮和锁销：经特殊热处理的碳钢
- 其他组件：碳钢镀锌或镀锌镍处理

TECHNICAL FEATURES AND OPTIONS

- Interchangeability: Jindong internal Standard
- Mechanical connection: Internal cams and locking pins
- Connection system: Rotating the lever
- Disconnection system: Rotating the lever
- Construction material and surface treatment
- Body plates in aluminum alloy oxidation
- Cams and pins in high resistance carbon steel with special heat treatment.
- Others components in carbon steel with zinc plating or zinc nickel treatment.



符合人体工程学的手柄，即使是在断开后管路中存在高残余压力的情况下也可方便连接。
Ergonomic lever for easy connection/disconnection even with high residual pressure in the circuit

Series 006KL

平面密封式模具快速接头
Flush-Faced Type
Quick Mold coupling



止回阀类型Valve Style: 平面阀 Flush-faced Poppet
锁定装置Locking: 钢球 Ball Locking
材质Materials: 黑铜和不锈钢
Brass and Stainless steel
尺寸Size: 1/4
额定流量Flow capacity: 16L L/min
额定压力 Max working pressure: 6 MPa
互换性Interchange: Rectus 006KL series

Series 29X

按钮式气动快速接头
Push-Button Type Pneumatic
Quick coupling



材质Materials
母体Socket: 不锈钢SUS316 Stainless steel SUS316
插头Plug: 不锈钢SUS316 Stainless steel SUS316
温度范围Temperature range: -20°C to +100°C
额定压力 Max working pressure: 1.6MPa
标准和互换性Standard and Compatibility: ISO6150-C
特征Feature:
单手锁紧One-hand operated
按钮式释放装置Push-button release device

Series 204

平面密封式快速接头
Flush-Faced Type Quick coupling



止回阀类型Valve Style: 平面阀 Flush-faced Poppet
锁定装置Locking: 钢球 Ball Locking
材质Materials: 黑铜和不锈钢
Brass and Stainless steel
尺寸Size: 1/4 3/8
额定流量Flow capacity: 12L~30L L/min
额定压力 Max working pressure: 1.5MPa
互换性Interchange: Rectus 204 206 series

Series TSA

卡扣式快速接头
Bayonet Type Quick coupling



止回阀类型Valve Style: 平面阀 Flush-faced Poppet
锁定装置Locking: 卡扣 Bayonet
材质Materials: 铝合金和不锈钢
Aluminium alloy and Stainless steel
尺寸Size: 1/4 3/8
额定流量Flow capacity: 8L~30L L/min
额定压力 Max working pressure: 16MPa
互换性Interchange: STAUBLI SPH series

Series TSF

盲插式流体快速接头
Blind plug flow Type Quick coupling



止回阀类型Valve Style: 平面阀 Flush-faced Poppet
锁定装置Locking: 盲插 Blind plug flow
材质Materials: 铝合金和不锈钢
Aluminium alloy and Stainless steel
尺寸Size: M8X0.75
额定流量Flow capacity: 2L L/min
额定压力 Max working pressure: 2MPa
互换性Interchange: walther 1-CO-003 series

Series CGD

盲插式流体快速接头
Blind plug flow Type Quick coupling



止回阀类型Valve Style: 平面阀 Flush-faced Poppet
锁定装置Locking: 盲插 Blind plug flow
材质Materials: 铝合金和不锈钢
Aluminium alloy and Stainless steel
尺寸Size: 1/8
额定流量Flow capacity: 2.5L L/min
额定压力 Max working pressure: 1.6MPa
互换性Interchange: STAUBLI CGO series

盐城市锦东液压机械产品系列代号

FF-02C-0/14BSP-SF

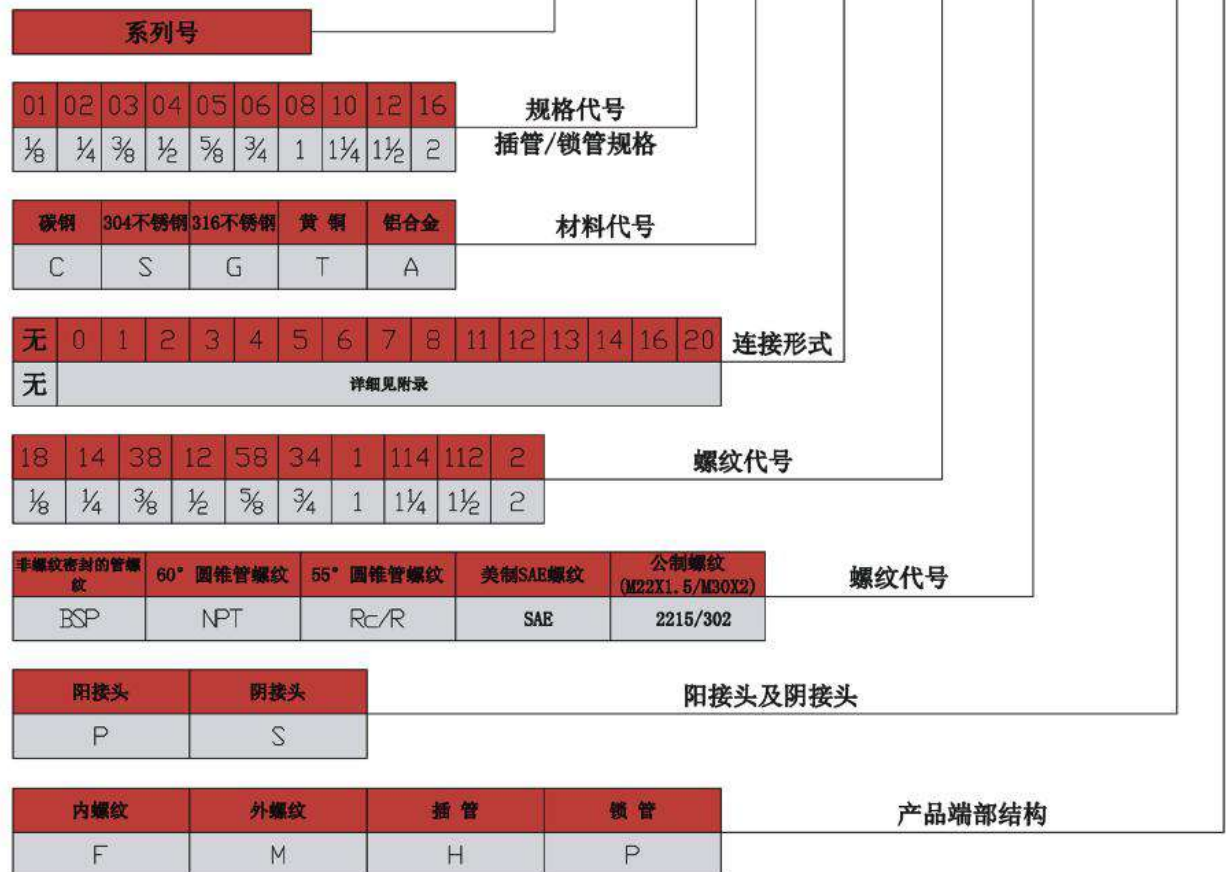

| | | | | | |
|---|---|---|-------------------|--|----------------------------------|
| F | 0 | 1 | 2 | 3 | 4 |
| DIN3852-2-X ANDI B1.20.3 DIN 3852-1-X | BS 5380 SAE J1926-1 ISO6149-1 | DIN3852-2-B SAE J1926-3 ISO6149-2 | ISO8434-1-L | ISO8434-1-S | ISO8434-6 |
| 5 | 6 | 7 | 8 | 9 | 11 |
| ISO8434-1-L | ISO8434-1-S | ISO8434-1-L | ISO8434-1-S | ISO5676 | CAE J 1453 |
| 12 | 13 | 14 | 16 | 21 | 22 |
| CAE J 1453 | CAE J 514 | CAE J 514 | ISO/CD 8434-6 | DIN 3852-1 tab.2 DIN 3852-1 tab.1 | DIN 3852-2-A DIN 3852-1-A |
| 27 | 28 | 44 | 76 | | |
| CAE J 1453 | CAE J 514 | ISO 6162-2 | ISO 6162-2 | | |