

**CHIP PHASE CONTROL THYRISTOR 1600V-55MM
ELECTRICAL CHARACTERISTICS**

	Symbol	Characteristic	Conditions	Temperature	Value
1	VDRM	Repetitive peak off state voltage		-30 °C ≤ Tj ≤ 125 °C	1600
2	VDSM	Non repetitive peak off state voltage		-30 °C ≤ Tj ≤ 125 °C	1700
3	VRRM	Repetitive peak reverse voltage		-30 °C ≤ Tj ≤ 125 °C	1600
4	VRSM	Non repetitive peak reverse voltage		-30 °C ≤ Tj ≤ 125 °C	1700
5	IDRM	Repetitive peak off state current	V=VDRM	Tj = 125 °C	≤ 70 mA
6	IRRM	Repetitive peak reverse current	V=VRRM	Tj = 125 °C	≤ 70 mA
7	ITSM	Peak surge(non repetitive) current	Sinewave,10ms without reverse voltage	Tj = 125 °C	36.0 kA
8	VTO	Threshold voltage		Tj = 125 °C	0.82V
9	Rt	On-state slope resistance		Tj = 125 °C	0.180 mohm
10	VT	On-state voltage	IT = 2500 A	Tj = 125 °C	≤ 1.45V
11	VT	On-state voltage	IT = 3500 A	Tj = 125 °C	≤ 1.65V
12	DI/DT	Critical rate of rise of on-state current, min.	From 75% VDRM up to 1650 A, gate 10V 5ohm	Tj = 125 °C	200 A / μ s
13	DV/DT	Critical rate of rise of off-state voltage, min.	Linear ramp up VD = 70 % VDRM	Tj = 125 °C	500 V / μ s
14	IH	Holding current, typical	VD=5V, gate open circuit	Tj = 25 °C	≤ 300 mA
15	IL	Latching current, typical	VD=5V, Tp=30 μs	Tj = 25 °C	≤ 700 mA
16	VGT	Gate trigger voltage	VD= 5V;	Tj = 25 °C	≤ 3.0 V
17	IGT	Gate trigger current	VD= 5V;	Tj = 25 °C	≤ 200 mA
18	VGD	Non-trigger gate voltage, min.	VD= VDRM	Tj = 125 °C	≥ 0.25 V
19	PGM	Peak gate power dissipation		Tj = 25 °C	150W
20	VFGM	Peak gate voltage (forward)		Tj = 25 °C	30V
21	IFGM	Peak gate current		Tj = 25 °C	10 A
22	VRGM	Peak gate voltage (reverse)		Tj = 25 °C	5V

CHIP PHASE CONTROL THYRISTOR 1600V-55MM

OUTLINE

Dimension :

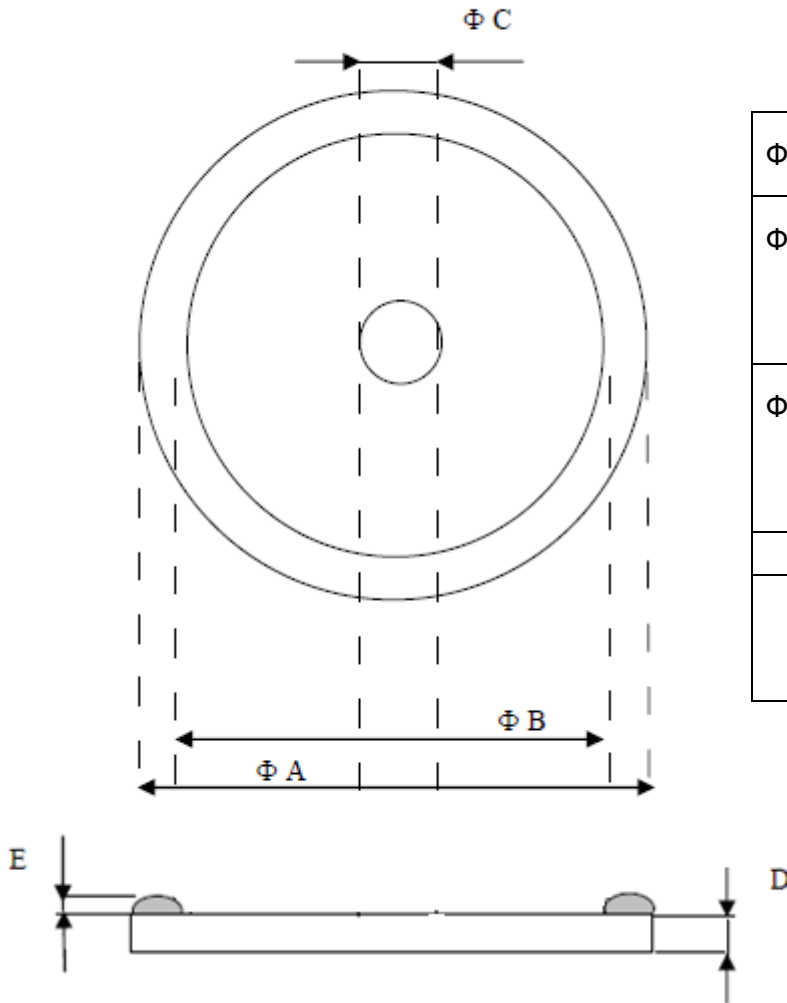

Φ A	Chip diameter	55 mm
Φ B	External Emitter Contact diameter = molybdenum washer external diameter	45~46mm
Φ C	Internal Emitter contac area =molybdenum washer internal	8.5~8.6mm
D	Chip thickness	2.4~2.7mm
E	Junction coating rubber maximum thickness	0.2~0.4mm

NOTE: This outline is for 55mm SCR fusion element.
 Junction have double Overcoats, the outside is Red.
 Cathode Surface Metal:10~15um Aluminium.
 Anode surface Metal:molybdenum



Tel: +86-514-87782298, 87782296

E-mail: positioning@china.com;

Web Site: www.Pst888.com

FAX: +86-514-87782297, 87367519

info@yzpst.com;

www.yzpstcc.com

yzpst@pst888.com

www.yzpst.net

www.yzpst.com